

Seedbed Tillage

COVER CROP ROLLER
for
Ripper-Stripper Strip-Tillage Tool

Part No. 601354

Foreword



This symbol identifies important safety messages. When you see it, read the message that follows and be alert to the possibility of personal injury.

Remember, safety instructions stated in this manual are for your protection. Read them carefully and follow them closely when working around or using this machine.

Read and study this manual completely before attempting to operate this implement. Take this manual to the field for handy reference when operating, adjusting, or servicing your machine.

When referenced, “Right-Hand” (RH) and “Left-Hand” (LH) side of the machine are determined by standing behind the machine and facing in the direction of travel.

IMPORTANT

The information, specifications, and illustrations in the manual are on the basis of information available at the time it was written. Due to continuing improvements in the design and manufacture of Unverferth products, all specifications and information contained herein are subject to change without notice.

PRE-OPERATION CHECKLIST

Hardware tightened

Machine lubricated

Safety and operating procedures reviewed

Field adjustment information reviewed

Table of Contents

Foreword2
Pre-Operation Checklist.....2

**SECTION I
Safety**

General Hazard Information 1-2
Following Safety Instructions 1-3
Before Servicing or Operating 1-3
During Operation 1-4
Before Transporting 1-4
During Transport..... 1-4
Preparing for Emergencies..... 1-5
Wearing Protective Equipment 1-5

**SECTION II
Set Up & Operation**

Installation 2-2
Layouts 2-10

**SECTION III
Maintenance**

Complete Torque Chart 3-2
Replacing Coulter Blades 3-4
Replacing Roller Bearing 3-5
 Mainframe Roller Bearing 3-5
 Wing Roller Bearing 3-6
 Rear Roller Bearing 3-8

**SECTION IV
Parts**

Mounting Brackets/Clamps 4-2
Roller Assemblies 4-4
Front Roller Components 4-6
Rear Roller & Deflector Components 4-8
Front Mounting Post Components 4-9
Rear Mounting Post Components 4-10

Notes

SECTION I

Safety

General Hazard Information	1-2
Following Safety Instructions	1-3
Before Servicing or Operating	1-3
During Operation	1-4
Before Transporting	1-4
During Transport.....	1-4
Preparing for Emergencies.....	1-5
Wearing Protective Equipment.....	1-5

General Hazard Information

No accident-prevention program can be successful without the wholehearted cooperation of the person who is directly responsible for the operation of the equipment.

A large number of accidents can be prevented only by the operator anticipating the result before the accident is caused and doing something about it. No power-driven equipment, whether it be transportation or processing, whether it be on the highway, in the field, or in the industrial plant, can be safer than the person who is at the controls. If accidents are to be prevented--and they can be prevented--it will be done by the operators who accept the full measure of their responsibility.

It is true that the designer, the manufacturer, and the safety engineer can help; and they will help, but their combined efforts can be wiped out by a single careless act of the operator.

It is said that, "the best kind of a safety device is a careful operator." We, at Unverferth Mfg. Co., Inc. ask that you be that kind of operator.



REMEMBER:
THINK SAFETY
A CAREFUL OPERATOR IS THE
BEST INSURANCE AGAINST AN
ACCIDENT!

SIGNAL WORDS

 **DANGER**

INDICATES AN EXTREMELY HAZARDOUS SITUATION OR ACTION THAT WILL RESULT IN SERIOUS INJURY OR DEATH.

 **WARNING**

INDICATES A HAZARDOUS SITUATION OR ACTION THAT COULD RESULT IN SERIOUS INJURY OR DEATH.

 **CAUTION**

INDICATES AN UNSAFE SITUATION OR ACTION THAT MAY RESULT IN PERSONAL INJURY.

IMPORTANT

Is used for instruction on operating, adjusting, or servicing a machine.

Following Safety Instructions

- Read and understand this operator's manual before operating.



- All machinery should be operated only by trained and authorized personnel.

- To prevent machine damage, use only attachments and service parts approved by the manufacturer.

- Always shut tractor engine off and remove key before servicing.

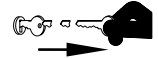

- Avoid personal attire such as loose fitting clothing, shoestrings, drawstrings, pants cuffs, long hair, etc., that may become entangled in moving parts.

- Do not allow anyone to ride on the implement. Make sure everyone is clear before operating machine or towing vehicle.



- Never attempt to operate implement unless you are in driver's seat.



Before Servicing or Operating

- Avoid working under an implement; however, if it becomes absolutely unavoidable, make sure the implement is safely blocked.



- Ensure that all applicable safety decals are installed and legible.

- When working around the implement, be careful not to be cut by sharp edges.

- Secure drawbar pin with safety lock and lock tractor drawbar in fixed position.

- Do not stand between towing vehicle and implement during hitching.

- Always make certain everyone and everything is clear of the machine before beginning operation.

- Add sufficient ballast to tractor to maintain steering and braking control at all times. Do not exceed tractor's lift capacity or ballast capacity.

- Inspect fields for buried utility lines (electric, natural gas, water, etc.). To find buried lines in the US or Canada contact 1-888-258-0808, in the US you may also contact 811.

During Operation

- Regulate speed to field conditions. Maintain complete control at all times.
- Never service or lubricate equipment when in operation.
- Keep away from overhead power lines. Electrical shock can cause serious injury or death.
- Use extreme care when operating close to ditches, fences, or on hillsides.
- Do not leave towing vehicle unattended with engine running.



Before Transporting

- Check for proper function of all available transport lights. Make sure that all reflectors are clean and in place on machine. Make sure that the SMV emblem and SIS decal are visible to approaching traffic.

During Transport

- Comply with all laws governing highway safety when moving machinery.
- Use transport lights as required by all laws to adequately warn operators of other vehicles.
- Use good judgment when transporting equipment on highways. Regulate speed to road conditions and maintain complete control.
- Slow down before making sharp turns to avoid tipping. Drive slowly over rough ground and side slopes.
- It is probable that this implement is taller, wider and longer than the towing vehicle. Become aware of and avoid all obstacles and hazards in the travel path of the equipment, such as power lines, ditches, etc.

Preparing for Emergencies

- Keep a first aid kit and properly rated fire extinguisher nearby.



- Keep emergency numbers for fire, rescue, and poison control personnel near the phone.



Wearing Protective Equipment

- Wear clothing and personal protective equipment appropriate for the job.



- Wear steel-toed shoes when operating.



- Wear hearing protection when exposed to loud noises.



- Do not wear additional hearing impairing devices such as radio headphones, etc



Notes

SECTION II
Set Up & Operation

Installation 2-2
Layouts 2-10

Installation

WARNING

- **FALLING OBJECTS CAN CAUSE SERIOUS INJURY OR DEATH. DO NOT WORK UNDER THE MACHINE AT ANY TIME WHILE BEING HOISTED. BE SURE ALL LIFTING DEVICES AND SUPPORTS ARE RATED FOR THE LOADS BEING HOISTED. THESE ASSEMBLY INSTRUCTIONS WILL REQUIRE SAFE LIFTING DEVICES UP TO 3,500 LBS. SPECIFIC LOAD RATINGS FOR INDIVIDUAL LOADS WILL BE GIVEN AT THE APPROPRIATE TIME IN THE INSTRUCTIONS.**
- **EYE PROTECTION AND OTHER APPROPRIATE PERSONAL PROTECTIVE EQUIPMENT MUST BE WORN WHILE SERVICING IMPLEMENT.**
- **KEEP HANDS CLEAR OF PINCH POINT AREAS.**

CAUTION

- **BE CAREFUL WHEN WORKING AROUND COULTER BLADES. FAILURE TO DO SO COULD RESULT IN PERSONAL INJURY DUE TO SHARP EDGES.**

1. Attach implement to tractor. Unfold wings if applicable and raise the implement off the ground.
2. Raise the rear jackstand (FIG. 1).
3. Lower implement to the ground.

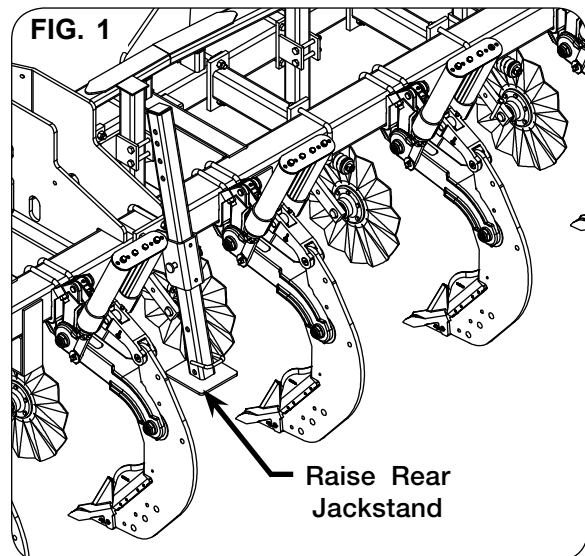

Installation (continued)

4. Using angled mounting bracket (601996B) provided, reposition the rear jackstand. Reference "Layouts" for proper repositioning.
5. Raise the implement off the ground.
6. Lower the rear jackstand.
7. Lower the implement to a firm level surface.

NOTE: Some applications (planter lift assist, gauge wheel location, etc.) may require rear storage stand placement between outer shanks. These situations may require a 2nd rear stand on the opposite end of the machine. Refer to your RIPPER-STRIPPER manual for components.

8. Using a safe lifting device rated for at least 250 lbs., remove all the original coulters assemblies and coulters mounting brackets. (FIG. 3)
9. Using a safe lifting device rated for at least 250 lbs., remove the stabilizer wheels from RIGID UNITS ONLY. (FIG. 3)

10. Using a safe lifting device rated for at least 750 lbs., position the appropriate roller assemblies under the front of the frame (FIG. 4). Refer to "Layouts" for positioning of roller assemblies. Align blades directly in front of ripper shanks. Verify the chevron blade pattern matches the diagrams shown in the "Overhead Layouts" in SET UP section.

NOTE: Some rollers may have longer drums and they are always used on outer ends of machine, refer to overhead layout.

NOTE: Roller assemblies have "direction of travel" arrow decal on top of roller frame.

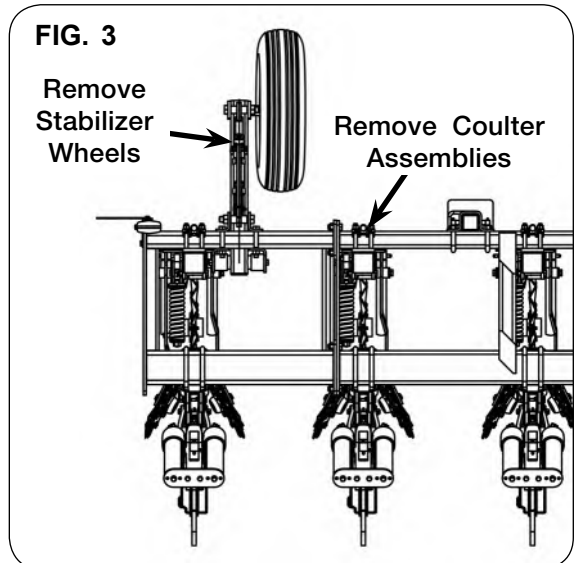
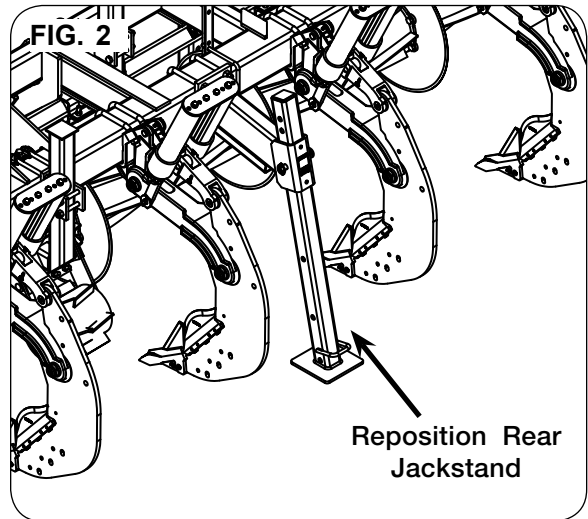

Installation (continued)

11. Install roller mounting brackets to the back-side of front ripper frame tube using hardware and castings provided. Refer to FIG. 5, FIG. 6, "Layouts", and PARTS section for positioning of mounting brackets. Torque hardware to "Torque Chart" specifications.

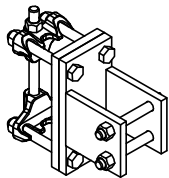
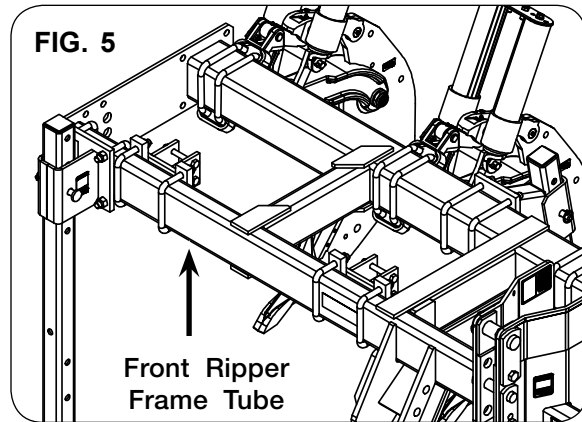
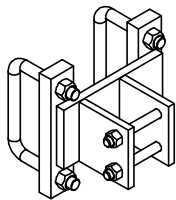
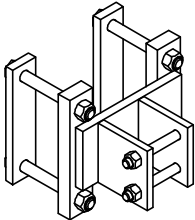

FIG. 6

**Front Ripper Frame Tube Post
Mounting Clamps/Bracket & Spacer Plate
With 5/8"-11UNC Capscrews**
Qty 2 - 8 Shank - 36" & 38" Spacing



**Front Ripper Frame Tube Post
Mounting Bracket with U-Bolts**
With 5/8"-11UNC Capscrews & 3/4"-10UNC U-Bolts
Qty 4 - 6 Shank - 30", 36", & 38" Spacing; 8 Shank - 30" Spacing
Qty 6 - 8 Shank - 36" & 38" Spacing
Qty 6 - 12 Shank - 36" & 38" Spacing



**Front Ripper Frame Tube Post
Mounting Bracket & Plates**
With 5/8"-11UNC Capscrews & 3/4"-10UNC Capscrews
Qty 2 - 12 Shank - 36" & 38" Spacing

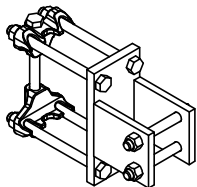

**Front Ripper Frame Tube Post
& Mounting Clamps/Bracket**
With 5/8"-11UNC Capscrews
Qty 6 - 12 Shank - 30" Spacing

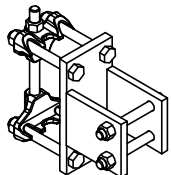

**Front Ripper Frame Tube Post
& Mounting Clamps/Bracket**
With 5/8"-11UNC Capscrews
Qty 4 - 12 Shank - 30" Spacing

Installation (continued)

12. Loosely install the front posts to the rear of the mounting brackets as shown in FIG. 6, FIG. 7 and FIG. 8 with 5/8"-11UNC x 5" capscrews (9390-134) and 5/8"-11UNC lock nuts (9800). Refer to "Layouts" for positioning of front posts.

Size of Unit	Qty of Front Posts (600309B) with 5/8"-11UNC Hardware	Qty of Front Posts (600734B) with 5/8"-11UNC Hardware
6 Shank 30" Spacing	4	-
6 Shank 36" Spacing	4	-
6 Shank 38" Spacing	4	-
8 Shank 30" Spacing	4	-
8 Shank 36" Spacing	6	2
8 Shank 38" Spacing	6	2
12 Shank 30" Spacing	4	6
12 Shank 36" Spacing	8	-
12 Shank 38" Spacing	8	-

13. Using a safe lifting device rated for at least 3,500 lbs., support Ripper-Stripper frame. Reposition the front jackstands and support brackets as needed. Reference "Layouts" for proper repositioning.

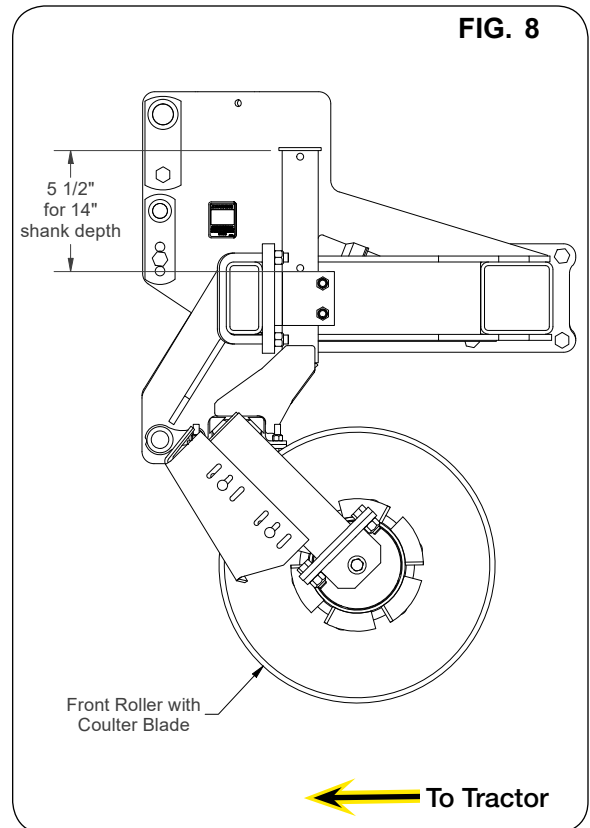
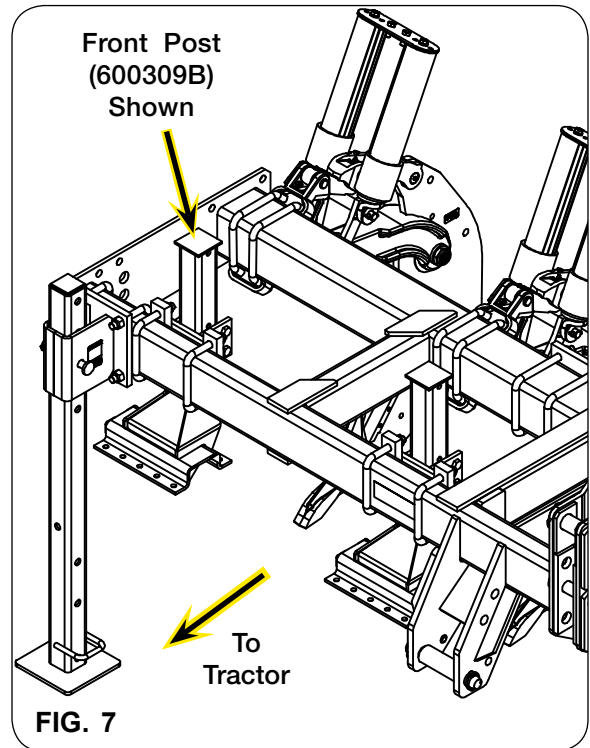

Installation (continued)

14. Using a safe lifting device rated for at least 750 lbs., support the roller U-frame. Loosely attach the clamp weldment (76950B & 600353B) to the front post (600309B & 600734B) using one longer 1/2"-13UNC x 2 1/2" capscrew in the center hole (will be replaced later) and 1/2"-13UNC lock nut (9800). (FIG. 9)

15. Install 1 1/2" Dia. x 11 1/2" neoprene springs (76956) in all 4 corners between the clamps and roller frame tube using rubber adhesive tape to assist assembly. (FIG. 9)

NOTE: Rubber adhesive tape is included to aid when assembling neoprene springs with mounting clamps. Apply rubber adhesive tape to each spring, place into each of the 4 corners of the clamps, assemble components.

16. Assemble with 1/2"-13UNC x 2" full thread capscrews (97369) and 1/2"-13UNC lock nuts (9800) in the opposite holes of the clamp. (FIG. 10)

17. Replace the 2 1/2" long capscrew, with 1/2"-13UNC x 2" full thread capscrew (97369). Fully and evenly torque all full thread 2" long capscrews. (FIG. 10)

18. Repeat steps 14 through 17 until all front posts are attached to the roller assemblies.

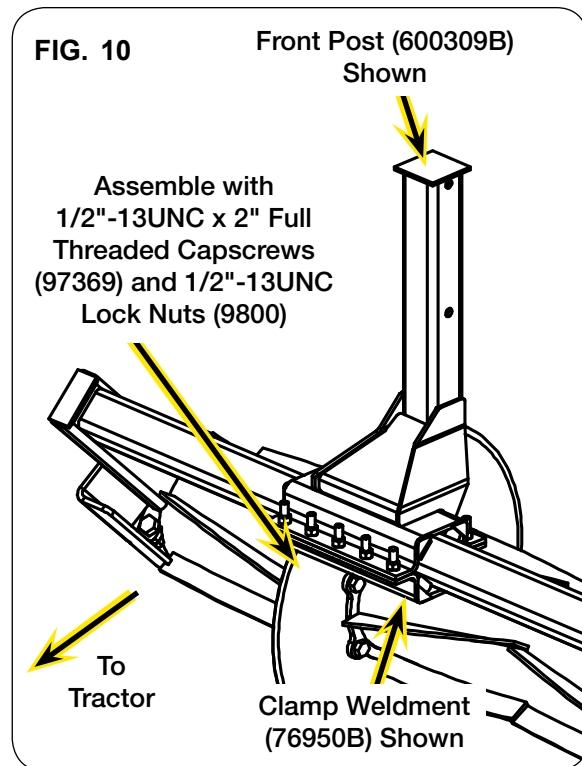
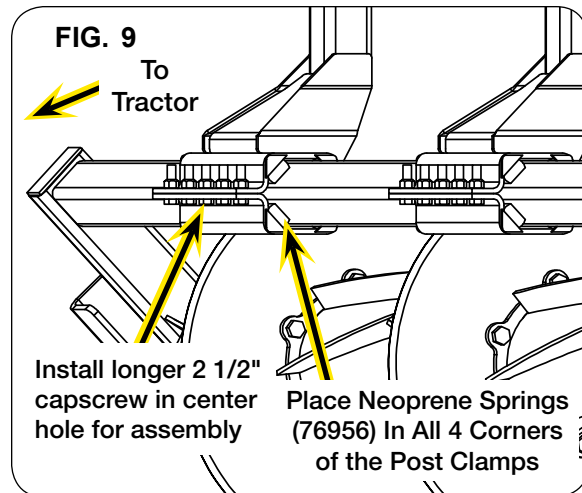

Installation (continued)

19. Install flush clamp weldment(s) (60245) to the backside of rear (6"x6") ripper frame tube using 5/8"-11UNC hardware and castings provided. Refer to FIG. 11 and "Layouts" for positioning of flush clamp weldment(s) (60245).

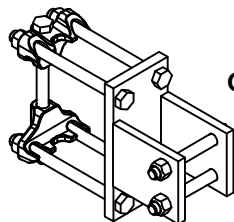

**Rear Ripper Frame Tube Post Mounting Clamps/Bracket
With 5/8"-11UNC Capscrews**

Qty 1 - 6 Shank - 30", 36", & 38" Spacing; 8 Shank - 30" Spacing
Qty 3 - 8 Shank - 36" & 38" Spacing; 12 Shank - 30", 36" & 38" Spacing

FIG. 11

20. Loosely install the rear posts to the rear of the flush clamp weldment(s) (60245) as shown in FIG. 12 with 5/8"-11UNC hardware.

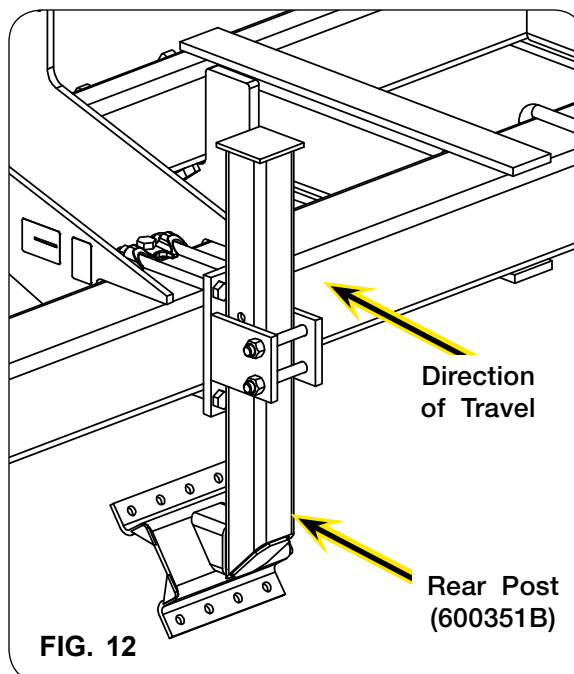

FIG. 12

Installation (continued)

- Using a safe lifting device rated for at least 150 lbs., support the rear roller assembly. Loosely attach the bottom rear post clamp to the rear post using 1/2"-13UNC x 2" full thread capscrews (97369) and 1/2"-13UNC locknuts (9800). (FIG. 13, FIG. 14, and FIG. 15)

NOTE: Insert a bolt or pin through hole in the rear post to temporarily set roller height position for 14" shank depth. (FIG. 13, FIG. 14, and FIG. 15)

- Install 1 1/2" Dia. x 8 1/2" neoprene springs (600355) in all 4 corners between the clamp and roller frame tube using adhesive tape (9502831) to assist assembly. (FIG. 13 and FIG. 14)
- Evenly and completely tighten all 4 full thread 2" long capscrews (FIG. 13 and FIG. 14). Torque hardware, refer to "Torque Chart".
- Repeat steps 21 through 23 until all rear posts are attached to the rear roller assemblies.

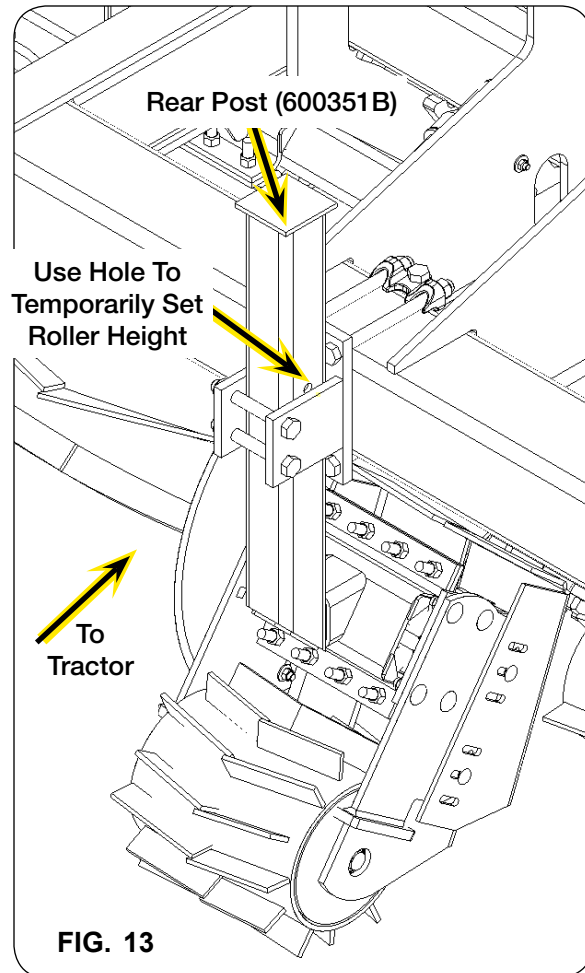

FIG. 13

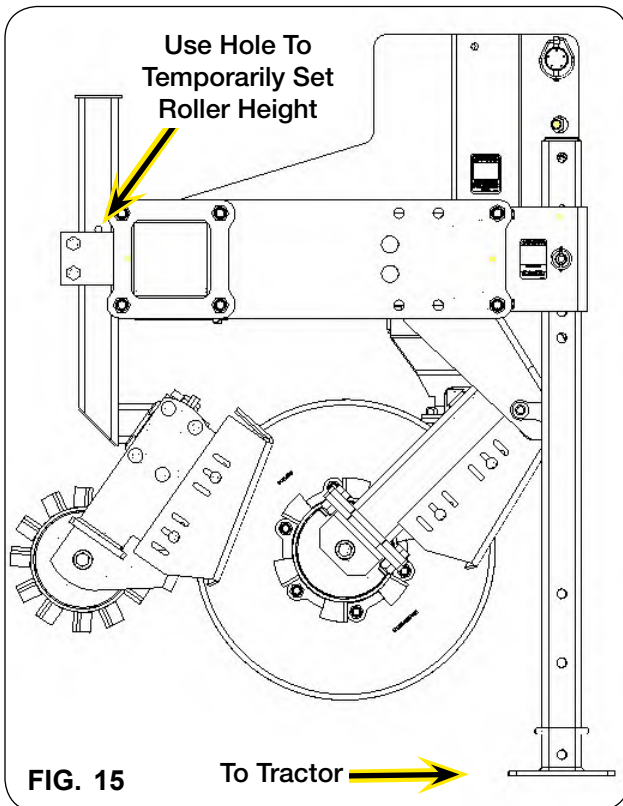

FIG. 15

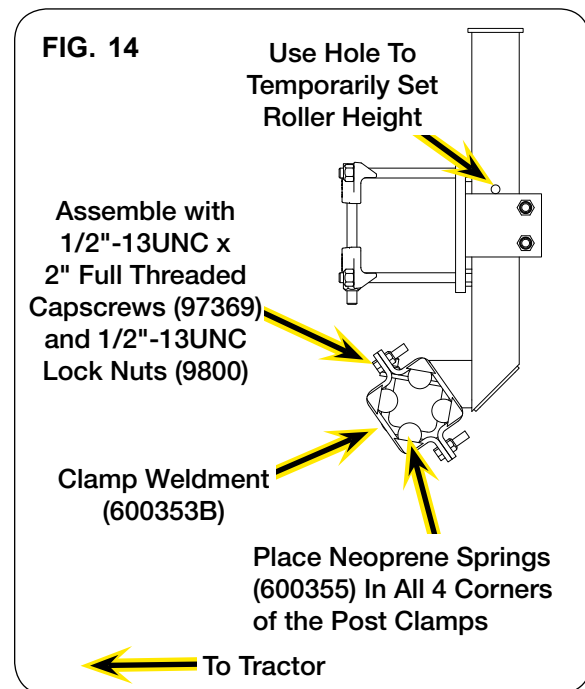
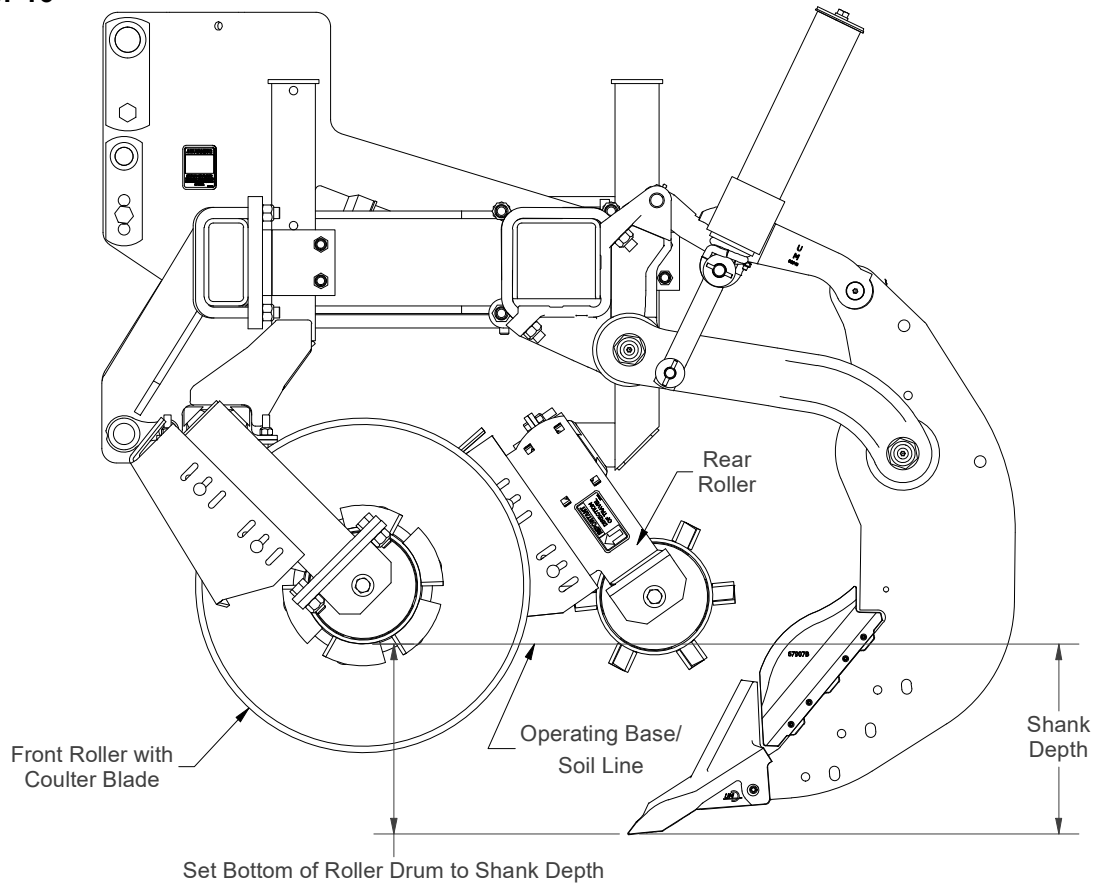

FIG. 14

Installation (continued)

25. Set bottom of roller to shank depth, measuring from ground to roller (FIG. 16). Torque hardware securing mounting post to 200 ft.-lbs. Refer to "Layouts" for positioning and post mounting clamps and hardware.

FIG. 16



NOTE: The roller should have enough down pressure to roll down and crimp cover crop, with 4-5" of upward travel remaining to flex over field obstacles and ground contours without damaging components. To increase pressure, lower roller. To decrease pressure, raise roller.

NOTE: Refer to your Ripper-Stripper manual for "Frame Leveling".

Layout - View of Frame Tube Post Mounting Brackets

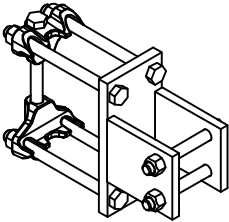

Rear Ripper Frame Tube Post Mounting Clamps/Bracket
Qty 1 - 6 Shank - 30", 36", & 38" Spacing; 8 Shank - 30" Spacing
Qty 3 - 8 Shank - 36" & 38" Spacing; 12 Shank - 30", 36" & 38" Spacing

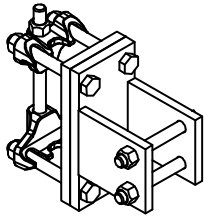

Front Ripper Frame Tube Post Mounting Clamps/Bracket & Spacer Plate
Qty 2 - 8 Shank - 36" & 38" Spacing

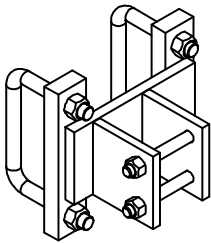

Front Ripper Frame Tube Post Mounting Bracket with U-Bolts
Qty 4 - 6 Shank - 30", 36", & 38" Spacing; 8 Shank - 30" Spacing
Qty 6 - 8 Shank - 36" & 38" Spacing
Qty 6 - 12 Shank - 36" & 38" Spacing

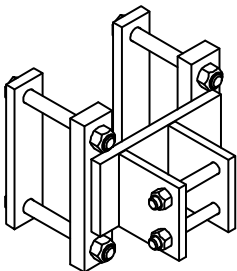

Front Ripper Frame Tube Post Mounting Bracket & Plates
Qty 2 - 12 Shank - 36" & 38" Spacing

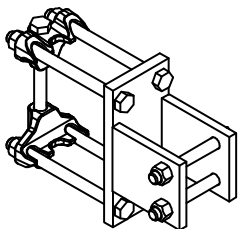

Front Ripper Frame Tube Post & Mounting Clamps/Bracket
Qty 6 - 12 Shank - 30" Spacing

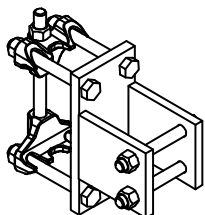

Front Ripper Frame Tube Post & Mounting Clamps/Bracket
Qty 4 - 12 Shank - 30" Spacing

Layout - 6 Shank 30" Spacing

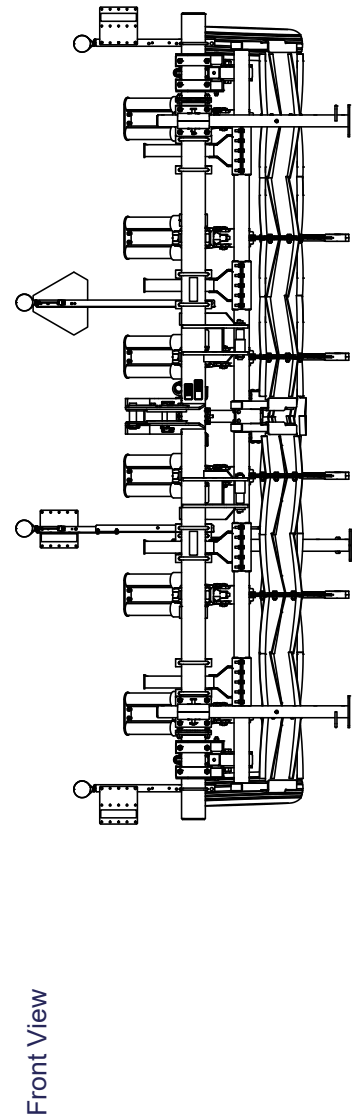
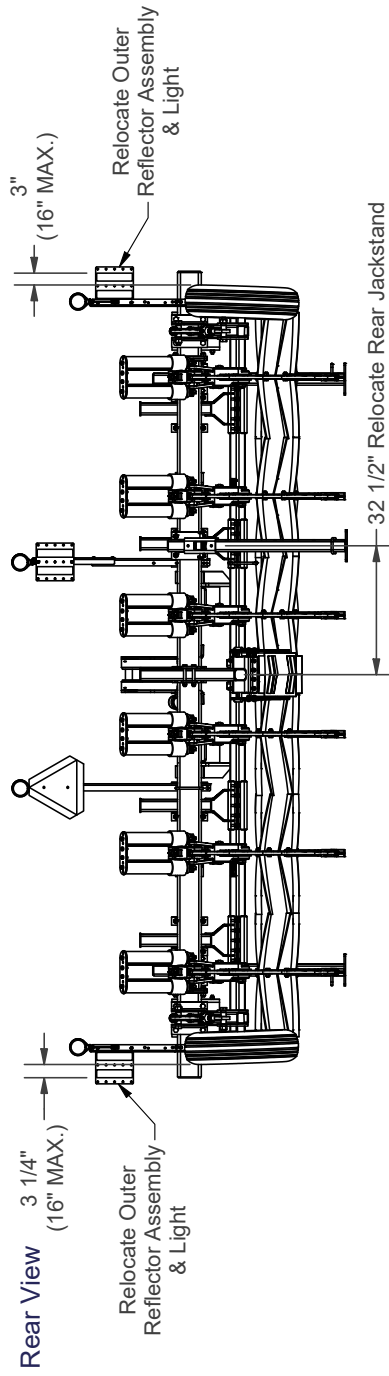
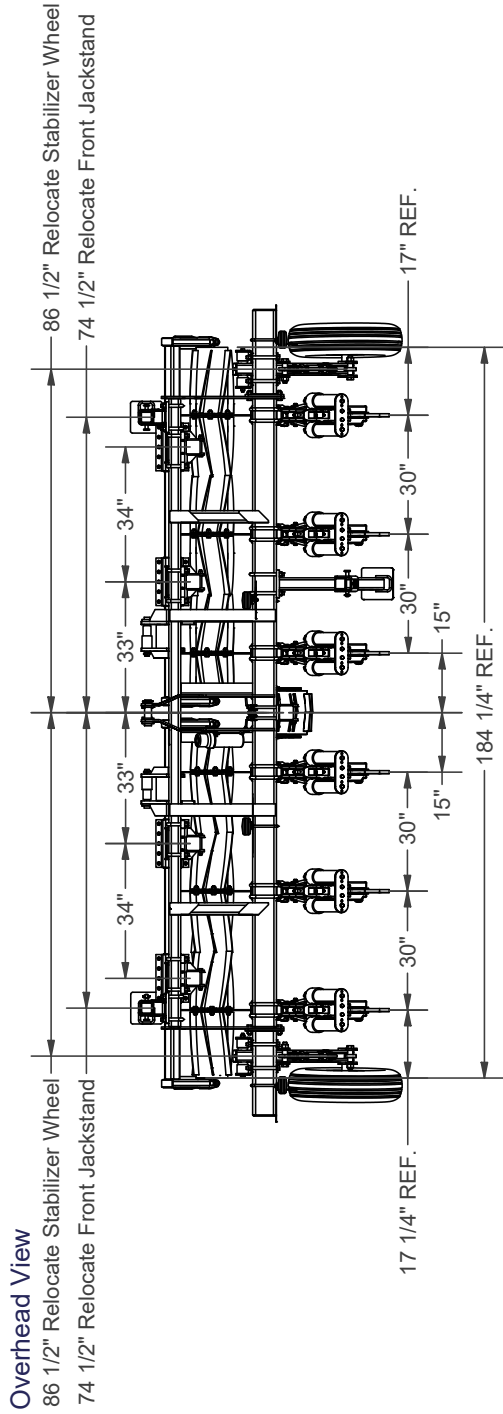

COVER CROP ROLLER ATTACHMENT — Set Up & Operation

Layout - 8 Shank 30" Spacing

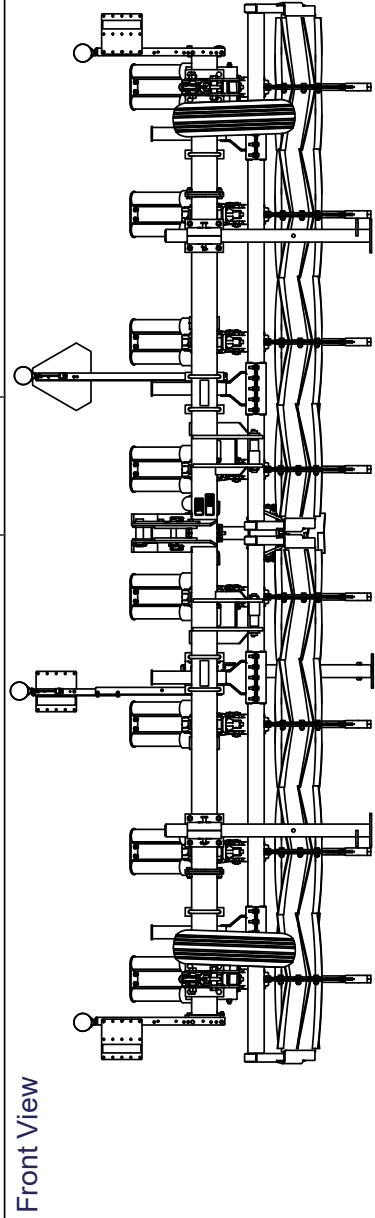
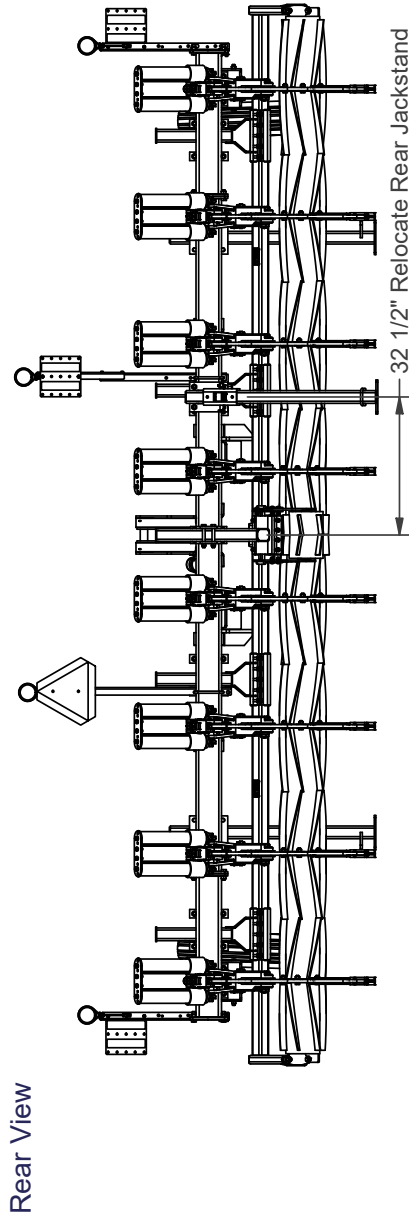
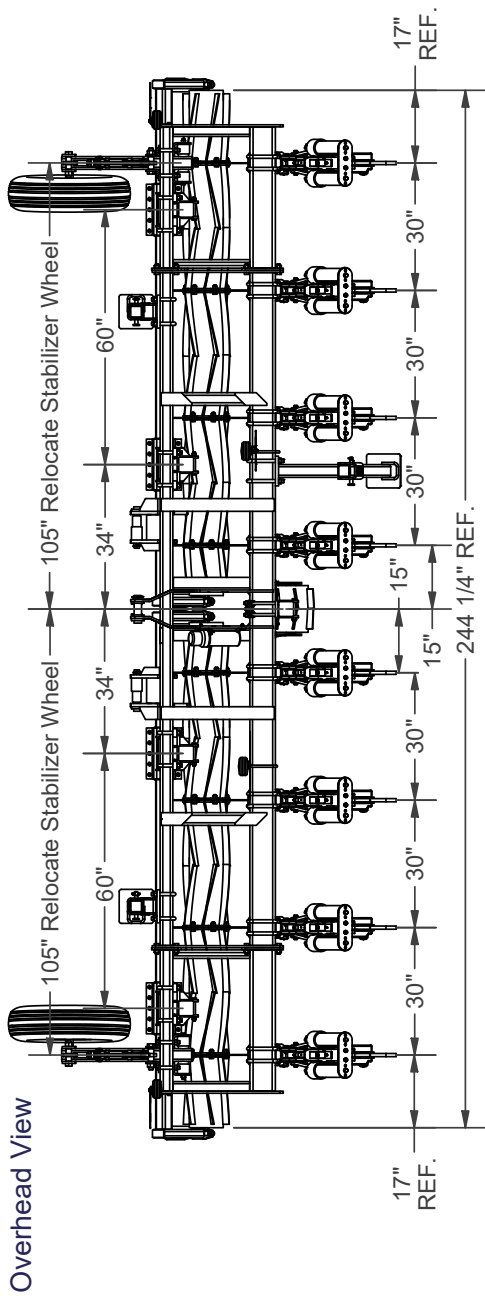

Layout - 8 Shank 36" Spacing

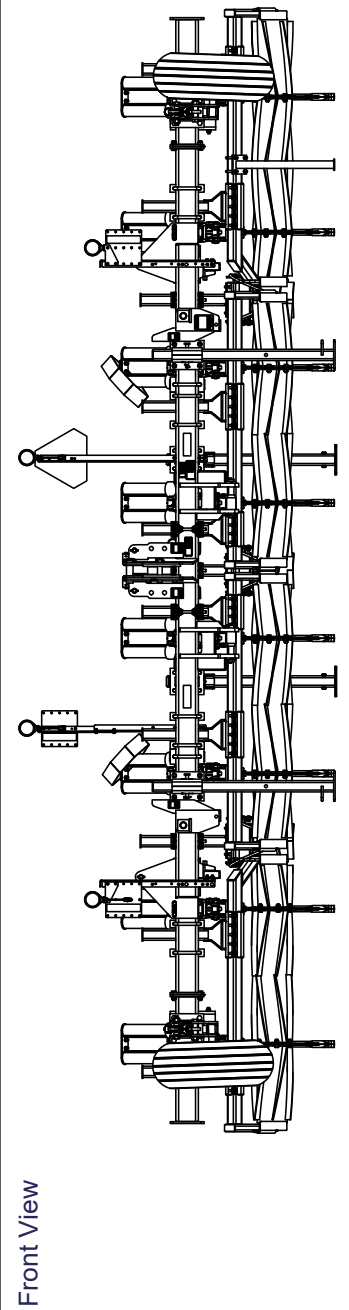
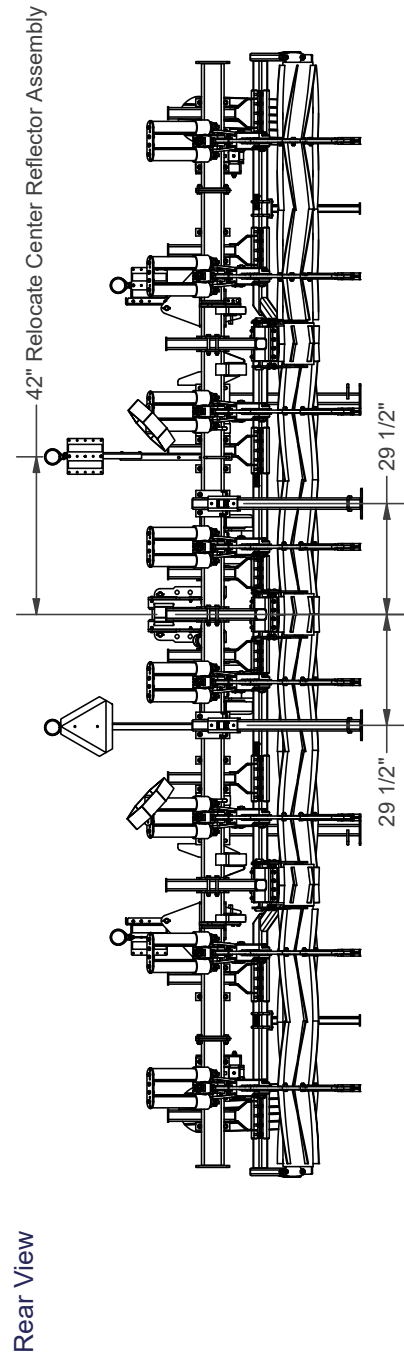
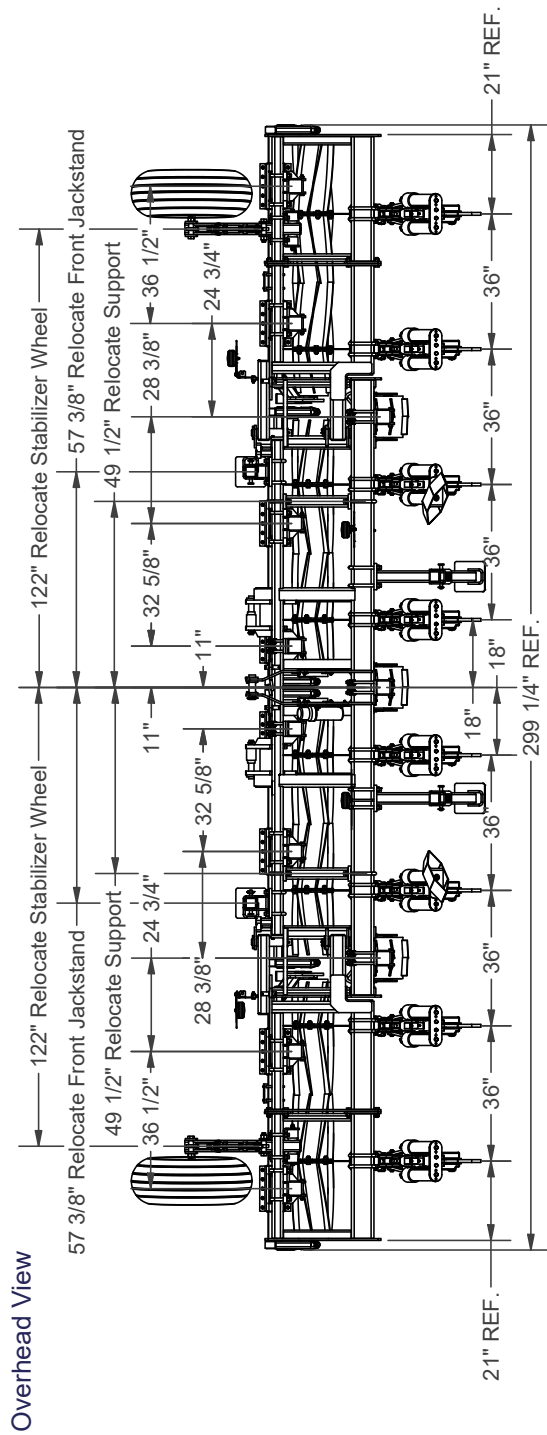

COVER CROP ROLLER ATTACHMENT — Set Up & Operation

Layout - 12 Shank 30" Spacing (continued)

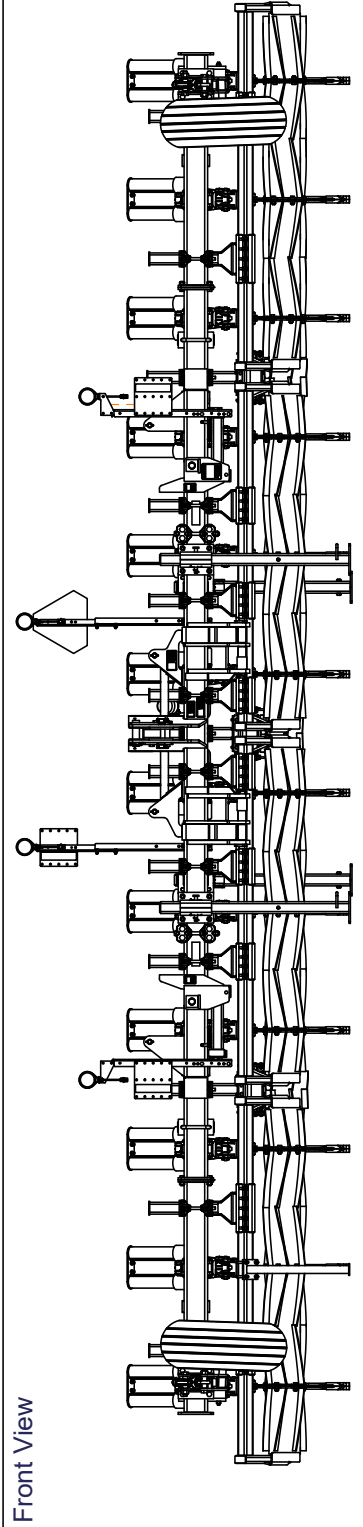
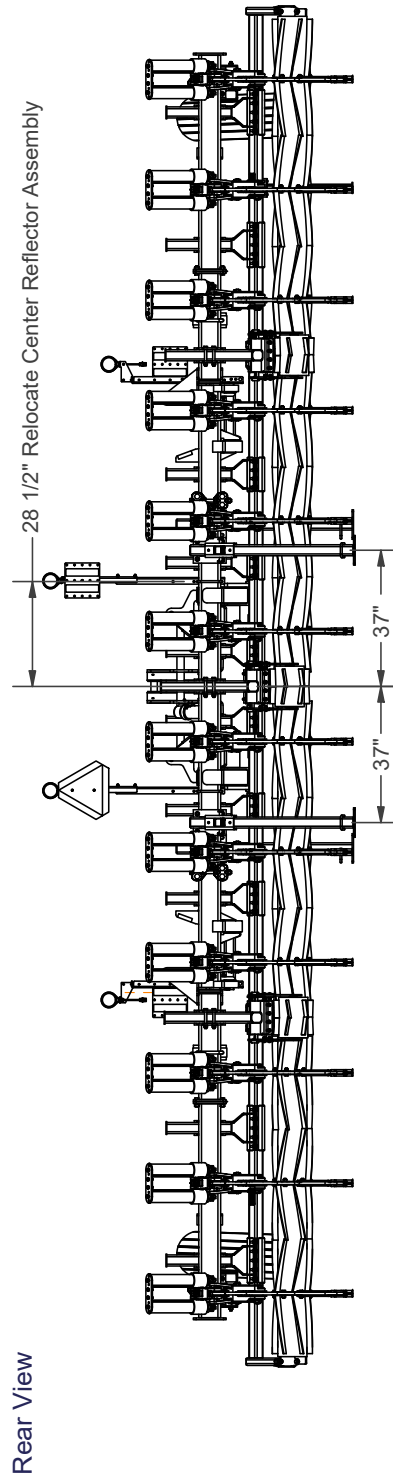
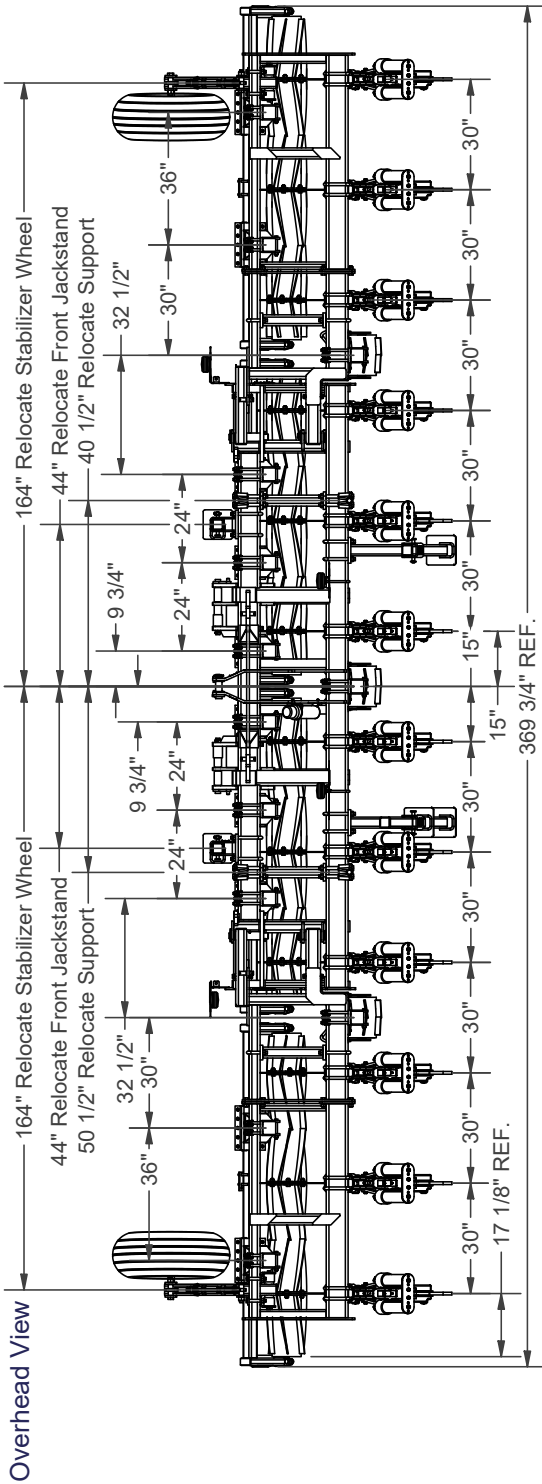

Layout - 12 Shank 38" Spacing

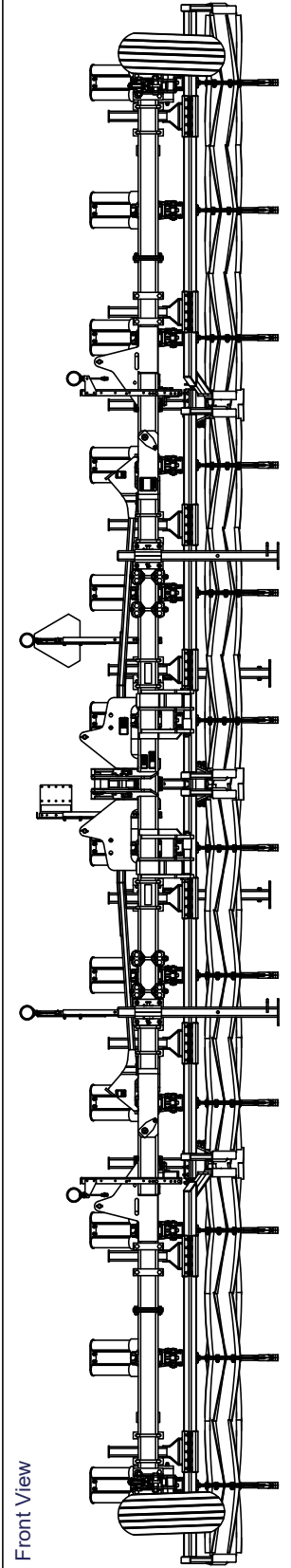
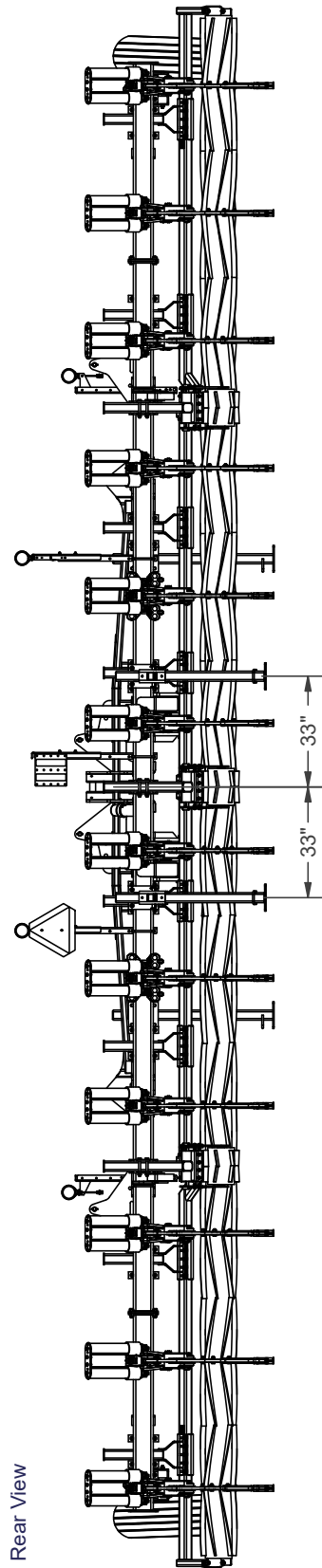
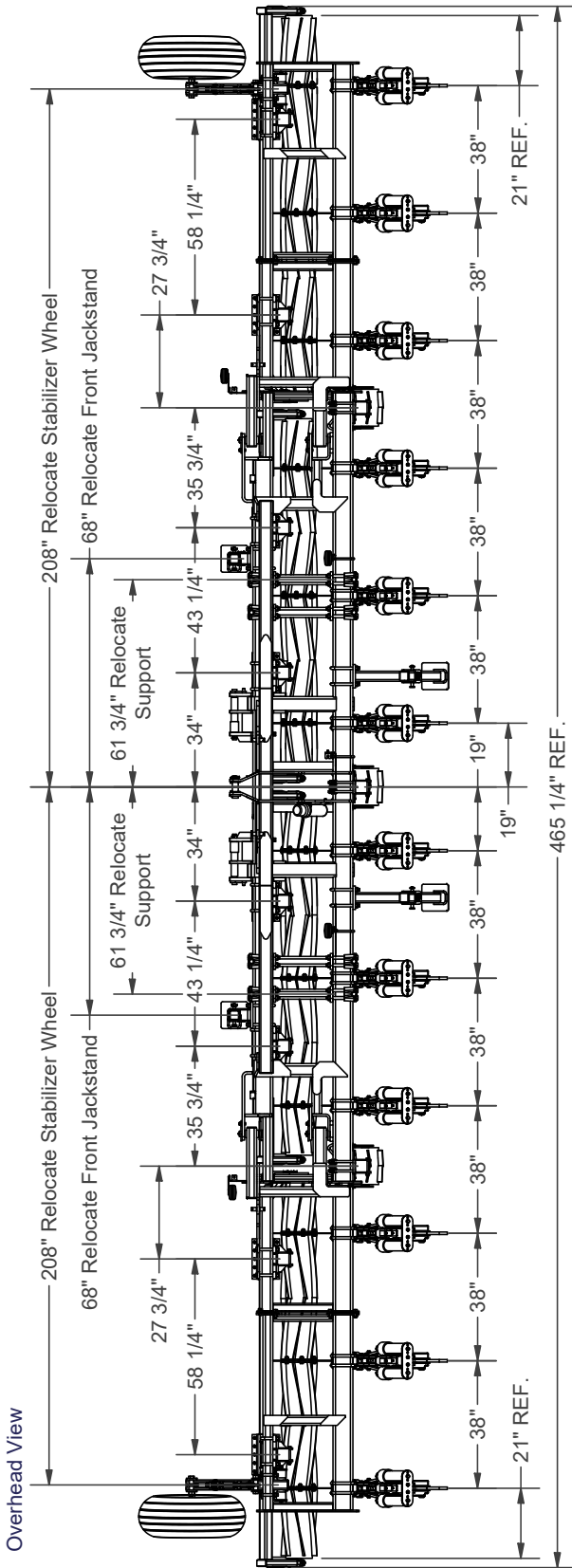

Notes

SECTION III

Maintenance

Complete Torque Chart	3-2
Replacing Coulter Blades	3-4
Replacing Roller Bearing	3-5
Mainframe Roller Bearing	3-5
Wing Roller Bearing	3-6
Rear Roller Bearing	3-8

Complete Torque Chart

Capscrews - Grade 5



NOTE:

- Grade 5 capscrews can be identified by three radial dashes on the head.
- For wheel torque requirements, refer to Wheels and Tires.
- Tighten U-bolts evenly and equally to have the same number of threads exposed on each end.

SIZE	FOOT POUNDS	NEWTON METERS
1/4-20	8-10	11-13
1/4-28	9-11	12-15
5/16-18	15-17	20-23
5/16-24	17-19	23-26
3/8-16	25-28	34-38
3/8-24	28-31	38-42
7/16-14	40-45	54-61
7/16-20	45-50	61-68
1/2-13	62-68	84-92
1/2-20	68-75	92-102
9/16-12	90-98	122-133
9/16-18	100-110	134-148
5/8-11	120-135	162-183
5/8-18	124-137	168-186
3/4-10	200-220	270-300
3/4-16	210-230	285-310
7/8-9	330-350	425-475
7/8-14	360-380	460-515
1-8	500-525	675-710
1-14	540-560	730-760
1 1/8-7	600-635	815-860
1 1/8-12	665-700	920-950
1 1/4-7	850-895	1150-1215
1 1/4-12	940-990	1275-1340
1 3/8-6	1125-1175	1525-1590
1 3/8-12	1280-1335	1735-1810
1 1/2-6	1500-1560	2035-2115
1 1/2-12	1685-1755	2285-2380

IMPORTANT

- Follow these torque recommendations except when specified in text.

Complete Torque Chart

Capscrews - Grade 8



NOTE:

- Grade 8 capscrews can be identified by six radial dashes on the head.
- For wheel torque requirements, refer to Wheels and Tires.
- Tighten U-bolts evenly and equally to have the same number of threads exposed on each end.

SIZE	FOOT POUNDS	NEWTON METERS
5/16-18 5/16-24	20-22 21-23	27-30 28-31
3/8-16 3/8-24	35-39 36-41	47-53 49-55
7/16-14 7/16-20	54-58 55-60	73-78 75-80
1/2-13 1/2-20	82-88 94-99	110-120 125-135
9/16-12 9/16-18	127-134 147-155	170-180 199-210
5/8-11 5/8-18	160-170 165-175	215-230 225-235
3/4-10 3/4-16	280-295 330-365	380-400 445-495
7/8-9 7/8-14	410-430 420-440	555-580 570-595
1-8 1-14	630-650 680-700	850-880 920-950
1 1/8-7 1 1/8-12	900-930 930-950	1220-1260 1260-1290
1 1/4-7 1 1/4-12	1250-1300 1280-1320	1695-1760 1735-1790

IMPORTANT

- *Follow these torque recommendations except when specified in text.*

Replacing Coulter Blade

⚠ WARNING

- EYE PROTECTION AND OTHER APPROPRIATE PERSONAL PROTECTIVE EQUIPMENT MUST BE WORN WHILE SERVICING THIS IMPLEMENT.
- KEEP HANDS CLEAR OF PINCH POINT AREAS.
- FALLING OBJECTS CAN CAUSE SERIOUS INJURY OR DEATH. DO NOT WORK UNDER THE MACHINE AT ANY TIME WHILE BEING HOISTED. BE SURE ALL LIFTING DEVICES AND SUPPORTS ARE RATED FOR THE LOADS BEING HOISTED. THESE ASSEMBLY INSTRUCTIONS WILL REQUIRE SAFE LIFTING DEVICES UP TO 750 LBS. SPECIFIC LOAD RATINGS FOR INDIVIDUAL LOADS WILL BE GIVEN AT THE APPROPRIATE TIME IN THE INSTRUCTIONS.
- MOVING PARTS CAN CRUSH AND CUT. KEEP AWAY FROM MOVING PARTS.

1. Park unit on a firm level surface. Unfold wings, lower the implement to the ground, set the tractor parking brake, depressurize the hydraulic system, shut off the engine, and remove the ignition key.

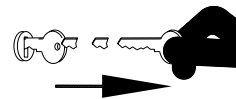

2. Using a safe lifting device rated for at least 750 lbs., support the roller assembly being revised and place supporting blocks of equal height under the drum rollers.

FIG. 2-1

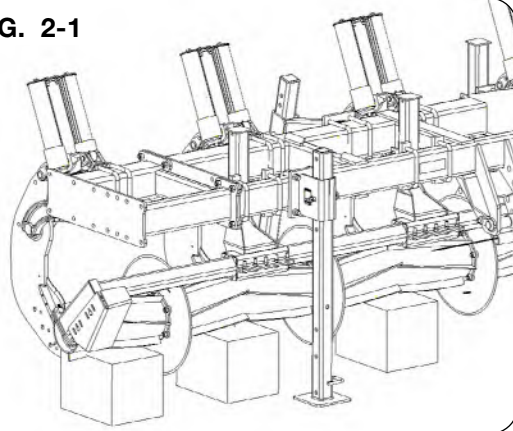

3. Remove the 5/8"-11UNC x 1 3/4" capscrews (9390-123) and 5/8"-11UNC lock nuts (9801) from the coulter blade (9501619) (FIG. 2-2).

4. Use a pry bar to separate the roller weldments 1/16" to 1/8" and replace the coulter blade (9501619) (FIG. 2-2).

5. Secure using 5/8"-11UNC x 1 3/4" capscrews (9390-123) and 5/8"-11UNC lock nuts (9801) previously removed (FIG. 2-2).

6. Torque lock nuts on carriage bolts to 120-135 ft.-lbs.

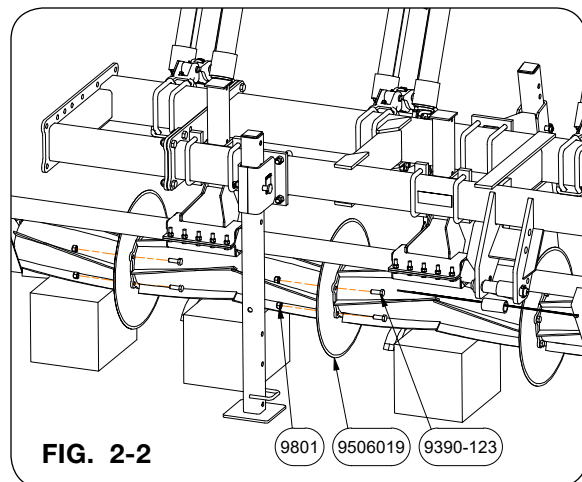
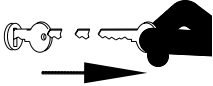

FIG. 2-2

9801 9506019 9390-123

Replacing Roller Bearing

WARNING

- EYE PROTECTION AND OTHER APPROPRIATE PERSONAL PROTECTIVE EQUIPMENT MUST BE WORN WHILE SERVICING THIS IMPLEMENT.
 - KEEP HANDS CLEAR OF PINCH POINT AREAS.
 - FALLING OBJECTS CAN CAUSE SERIOUS INJURY OR DEATH. DO NOT WORK UNDER THE MACHINE AT ANY TIME WHILE BEING HOISTED. BE SURE ALL LIFTING DEVICES AND SUPPORTS ARE RATED FOR THE LOADS BEING HOISTED. THESE ASSEMBLY INSTRUCTIONS WILL REQUIRE SAFE LIFTING DEVICES UP TO 750 LBS. SPECIFIC LOAD RATINGS FOR INDIVIDUAL LOADS WILL BE GIVEN AT THE APPROPRIATE TIME IN THE INSTRUCTIONS.
 - MOVING PARTS CAN CRUSH AND CUT. KEEP AWAY FROM MOVING PARTS.
1. Park unit on a firm level surface. Unfold wings, lower the implement to the ground, set the tractor parking brake, depressurize the hydraulic system, shut off the engine, and remove the ignition key. 
 2. Using a safe lifting device rated for at least 750 lbs., support the affected roller assembly by placing supporting blocks under the drum rollers. (FIG. 2-3)

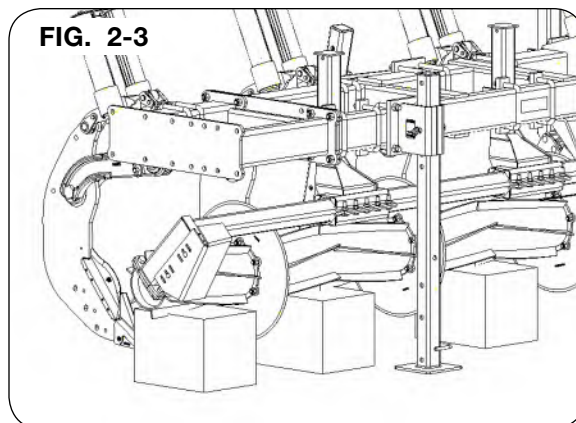

Mainframe Roller Weldment

3. Remove the 3/4"-10UNC x 2" capscrews (9390-145) and 3/4"-10UNC lock nuts (9802) from the bearing mount weldment (600325B) (FIG. 2-4).

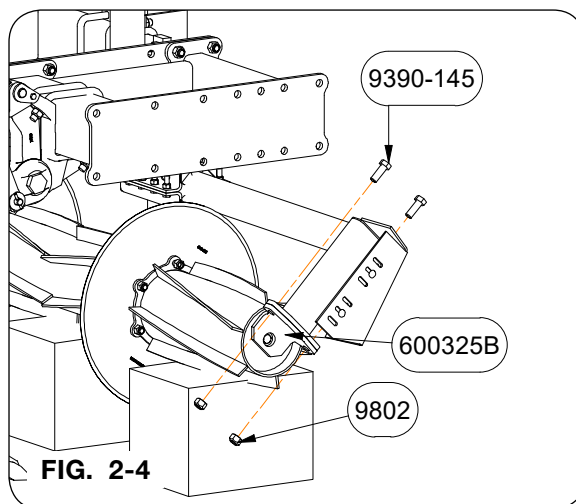

Replacing Roller Bearing (continued)

4. Remove the 5/8"-11UNC x 1 1/4" capscrew (900872) from the bearing mount weldment (600325B) and square bearing bolt (74280) on the end of the roller assembly. (FIG. 2-5)
5. Remove the 1/2"-20UNF elastic lock nuts (9398-015) from the flange bearing (902714). (FIG. 2-5)
6. Replace flange bearing (902714) and insert the square bearing bolt (74280) (FIG. 2-5).
7. Secure the flange bearing (902714) to the roller weldment with 1/2"-20UNF elastic lock nuts (9398-015) (FIG. 2-5).
8. Secure the bearing mount weldment (600325B) to the roller weldment with 5/8"-11UNC x 1 1/4" capscrew (900872) Torque to 135 Ft.-Lbs. (FIG. 2-5)

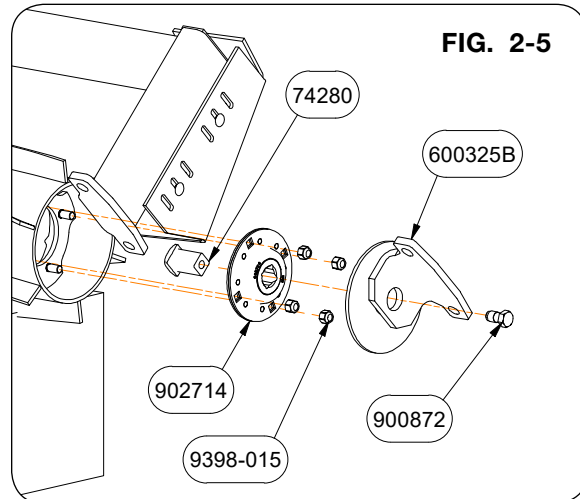

IMPORTANT

- The bearing bolt (square cast insert) **MUST** fully engage the square recess in the frame side plate to prevent machine damage. Make certain the bearing bolt is fully engaged before tightening the 5/8"-11UNC x 1 1/4" capscrew (900872).
9. Secure bearing mount weldment (600325B) on roller to the roller frame with 3/4"-10UNC x 2" capscrews (9390-145) and 3/4"-10UNC lock nuts (9802). (FIG. 2-6)

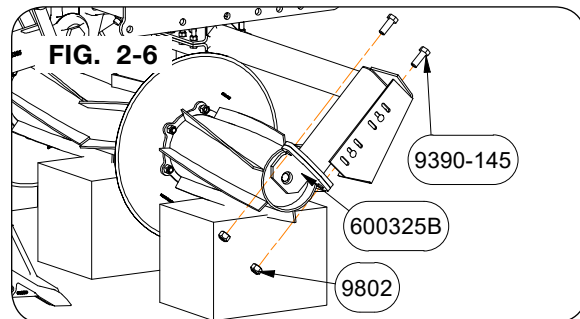

Wing Roller Weldment

3. Remove the 5/8"-11UNC x 1 1/4" capscrews (900872) from the bearing mount weldment (604725B). (FIG. 2-7)

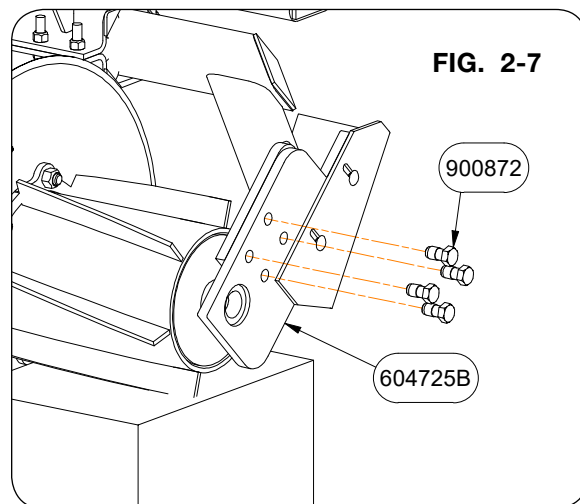

Replacing Roller Bearing (continued)

4. Remove the 5/8"-11UNC x 1 1/4" capscrew (900872) from the bearing mount weldment (600325B) and square bearing bolt (74280) on the end of the roller assembly. (FIG. 2-8)
5. Remove the 1/2"-20UNF elastic lock nuts (9398-015) from the flange bearing (902714). (FIG. 2-8)
6. Replace flange bearing (902714) and insert the square bearing bolt (74280). (FIG. 2-8)
7. Secure the flange bearing (902714) to the roller weldment with 1/2"-20UNF elastic lock nuts (9398-015). (FIG. 2-8)
8. Secure the bearing mount weldment (600325B) to the roller weldment with 5/8"-11UNC x 1 1/4" capscrew (900872). Torque to 135 Ft.-Lbs. (FIG. 2-8)

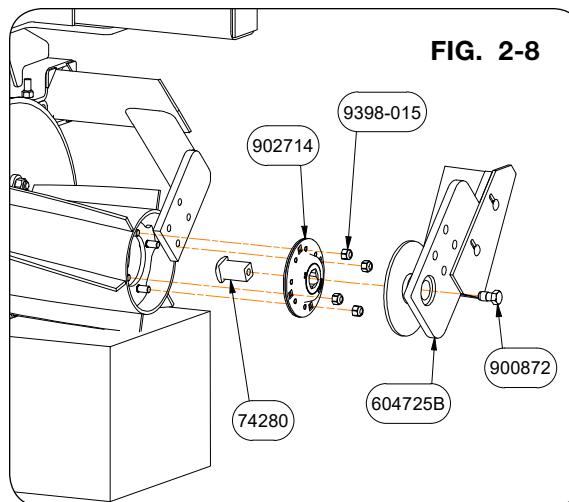

IMPORTANT

- The bearing bolt (square cast insert) **MUST** fully engage the square recess in the frame side plate to prevent machine damage. Make certain the bearing bolt is fully engaged before tightening the 5/8"-11UNC x 1 1/4" capscrew (900872).
9. Secure bearing mount weldment (600725B) on roller to the roller frame with the 5/8"-11UNC x 1 1/4" capscrews (900872) from the bearing mount weldment (604725B). (FIG. 2-9)

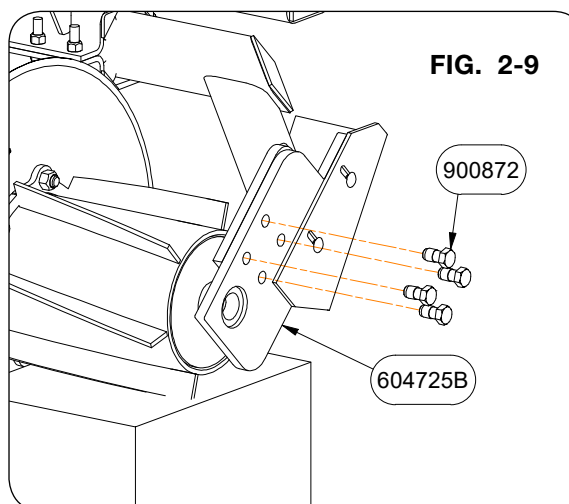

Replacing Roller Bearing (continued)

Rear Roller Weldment

- Remove the 1/2"-13UNC x 1 1/2" carriage bolts (9388-104) and 1/2"-13UNC locknuts (9800) from the bearing mount weldment (603717B). (FIG. 2-10)

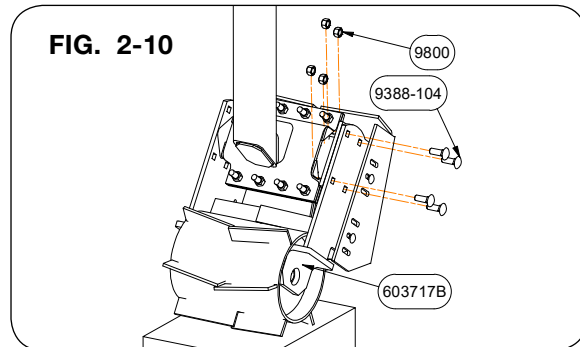

- Remove the 5/8"-11UNC x 1 1/4" capscrew (900872) from the bearing mount weldment (603717B) and square bearing bolt (74280) on the end of the roller assembly. (FIG. 2-11)
- Remove the 1/2"-20UNF elastic lock nuts (9398-015) from the flange bearing (902714). (FIG. 2-11)
- Replace flange bearing (902714) and insert the square bearing bolt (74280) (FIG. 2-11).
- Secure the flange bearing (902714) to the roller weldment with 1/2"-20UNF elastic lock nuts (9398-015) (FIG. 2-11).
- Secure the bearing mount weldment (600325B) to the roller weldment with 5/8"-11UNC x 1 1/4" capscrew (900872) Torque to 135 Ft.-Lbs. (FIG. 2-11)

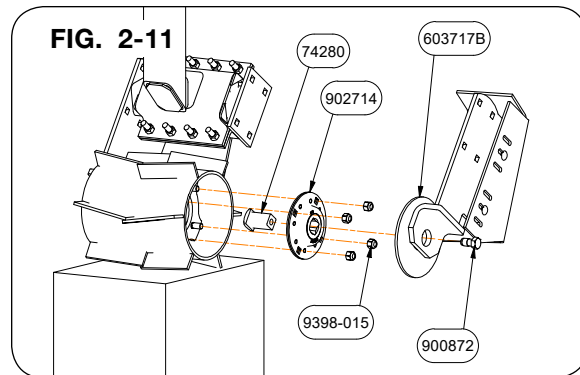

IMPORTANT

- The bearing bolt (square cast insert) **MUST** fully engage the square recess in the frame side plate to prevent machine damage. Make certain the bearing bolt is fully engaged before tightening the 5/8"-11UNC x 1 1/4" capscrew (900872).
- Secure bearing mount weldment (603717B) on roller to the roller frame with 1/2"-13UNC x 1 1/2" carriage bolts (9388-104) and 1/2"-13UNC locknuts (9800). (FIG. 2-12)

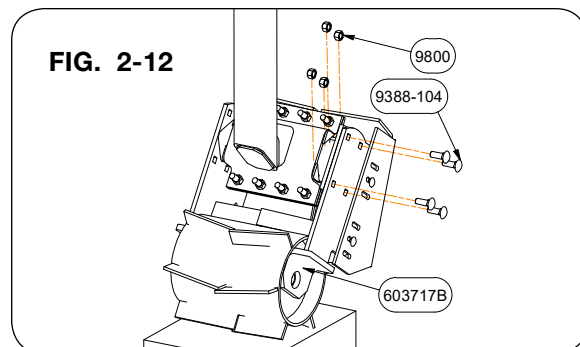

SECTION IV

Parts

Mounting Brackets/Clamps..... 4-2
Roller Assemblies..... 4-4
Front Roller Components 4-6
Rear Roller & Deflector Components 4-8
Front Mounting Post Components..... 4-9
Rear Mounting Post Components 4-10

COVER CROP ROLLER ATTACHMENT — Parts

Mounting Brackets/Clamps

Please visit www.unverferth.com/parts/ for the most current parts listing.

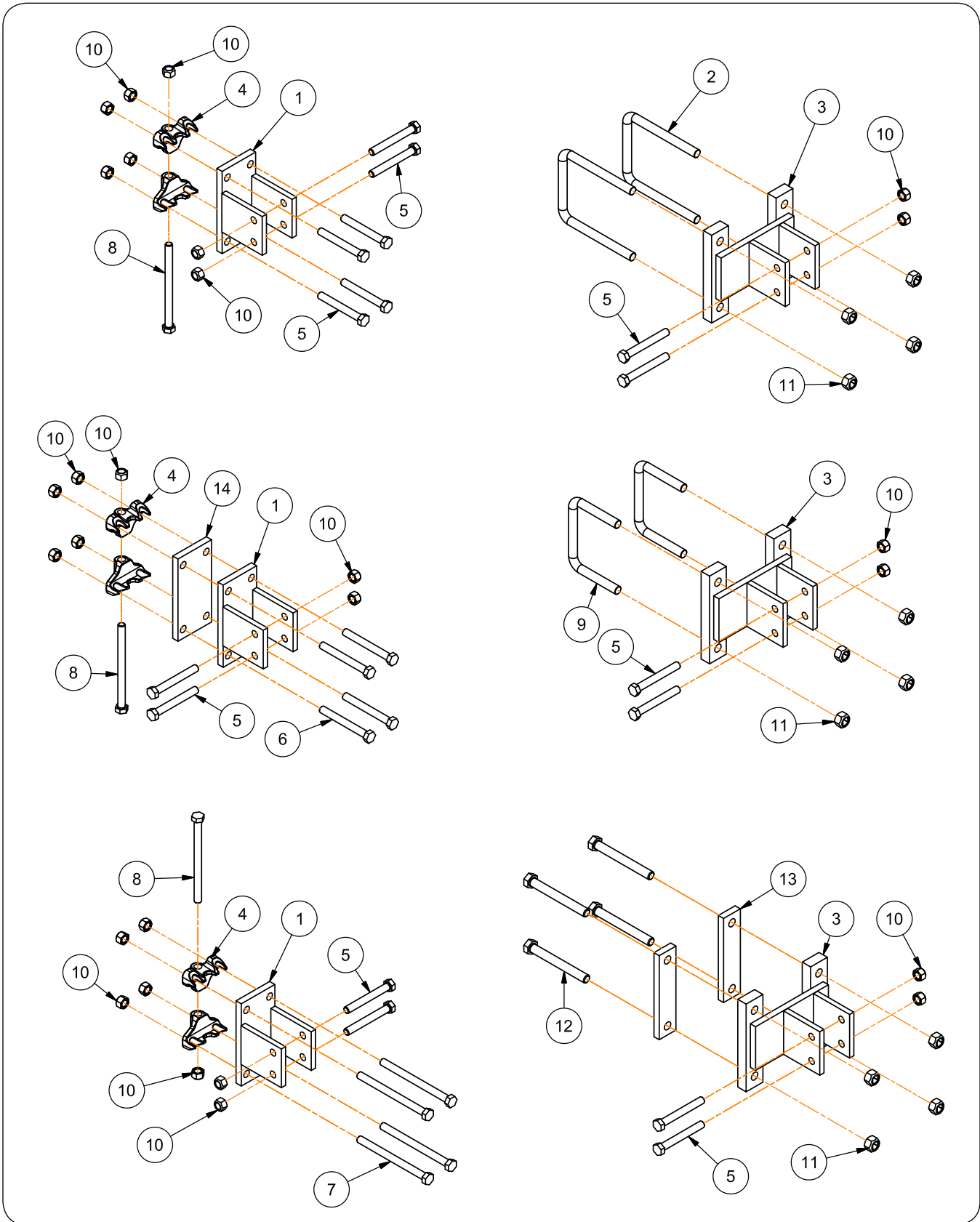

COVER CROP ROLLER ATTACHMENT — Parts

Mounting Brackets/Clamps

Please visit www.unverferth.com/parts/ for the most current parts listing.

ITEM	PART NO.	DESCRIPTION	6 SHANK 30", 36", & 38" SPACING 8 SHANK 30" SPACING	8 SHANK 36" & 38" SPACING	12 SHANK 30" SPACING	12 SHANK 36" SPACING	12 SHANK 38" SPACING
1	60245	6" Flush Clamp Weldment	1	5	13	3	3
2	94090	U-Bolt 3/4"-10UNC x 8"	-	-	-	8	8
3	62546	Offset Bracket Weldment	4	6	-	8	8
4	67922B	Extension Clamp	2	10	26	6	6
5	9390-134	Capscrew 5/8"-11UNC x 5"	10	22	42	22	22
6	9390-135	Capscrew 5/8"-11UNC x 5 1/2"	-	8	-	-	-
7	9390-140	Capscrew 5/8"-11UNC x 8"	4	12	36	12	12
8	9390-441	Capscrew 5/8"-11UNC x 8 1/2"	1	5	13	3	3
9	94012	U-Bolt 3/4"-10UNC x 5"	8	12	-	4	4
10	9801	Locknut 5/8"-11UNC	15	47	91	37	37
11	9802	Locknut 3/4"-10UNC	16	24	-	32	32
12	9390-158	Capscrew 3/4"-10UNC x 6 1/2"	-	-	-	8	8
13	67736B	Bar/Plate 5/8" x 2" x 8 11/16"	-	-	-	4	4
14	60791B	Spacer Plate 5/8" x 4" x 8 1/2"	-	2	-	-	-

COVER CROP ROLLER ATTACHMENT — Parts

Roller Assemblies

Please visit www.unverferth.com/parts/ for the most current parts listing.

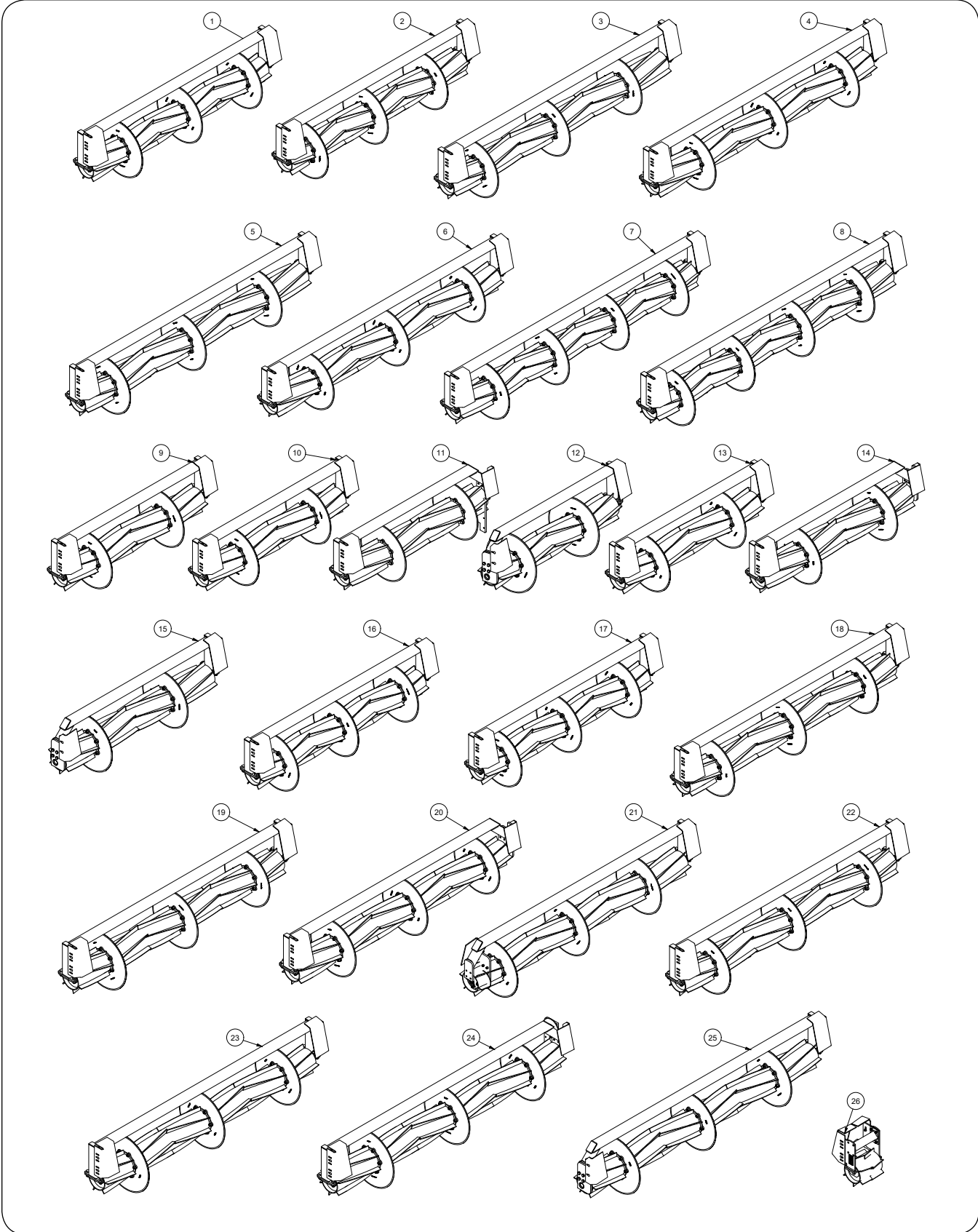

COVER CROP ROLLER ATTACHMENT — Parts

Roller Assemblies

Please visit www.unverferth.com/parts/ for the most current parts listing.

ITEM	PART NUMBER	DESCRIPTION Spacing	6 SHANK			8 SHANK			12 SHANK		
			30"	36"	38"	30"	36"	38"	30"	36"	38"
1	600455B	Roller Assembly 8" Dia. Right-Hand, 3 Blade, 30" Spg. - 93 3/16" =Black=	1	-	-	-	-	-	1	-	-
2	600462B	Roller Assembly 8" Dia. Left-Hand, 3 Blade, 30" Spg. - 93 3/16" =Black=	1	-	-	-	-	-	1	-	-
3	600518B	Roller Assembly 8" Dia. Left-Hand, 3 Blade, 36" Spacing - 112 15/16" =Black=	-	1	-	-	-	-	-	-	-
4	600519B	Roller Assembly 8" Dia. Right-Hand, 3 Blade, 36" Spacing - 112 15/16" =Black=	-	1	-	-	-	-	-	-	-
5	600872B	Roller Assembly 8" Dia. Left-Hand, 3 Blade, 38" Spg. - 117 1/4" =Black=	-	-	1	-	-	-	-	-	1
6	600875B	Roller Assembly 8" Dia. Right-Hand, 3 Blade, 38" Spg. - 117 1/4" =Black=	-	-	1	-	-	-	-	-	1
7	600623B	Roller Assembly 8" Dia. Right-Hand, 4 Blade, 30" Spg. - 124 9/32" =Black=	-	-	-	1	-	-	-	-	-
8	600624B	Roller Assembly 8" Dia. Left-Hand, 4 Blade, 30" Spg. - 124 9/32" =Black=	-	-	-	1	-	-	-	-	-
9	600531B	Roller Assembly 8" Dia. Center Left-Hand, 2 Blade, 36" Spg. - 74 1/4" =Black=	-	-	-	-	1	-	-	-	-
10	600824B	Roller Assembly 8" Dia. Center Right-Hand, 2 Blade, 36" Spg. - 74 1/4" =Black=	-	-	-	-	1	-	-	-	-
11	600691B	Roller Assembly 8" Dia. Right-Hand, 2 Blade, 36" Spg. - 73 25/32" =Black=	-	-	-	-	1	-	-	-	-
12	600677B	Roller Assembly 8" Dia. Left-Hand, 2 Blade, 36" Spg. - 73 25/32" =Black=	-	-	-	-	1	-	-	-	-
13	600415B	Roller Assembly 8" Dia. Center, 2 Blade, 38" Spg. - 73 7/16" =Black=	-	-	-	-	-	2	-	-	-
14	600442B	Roller Assembly 8" Dia. Right-Hand, 2 Blade, 38" Spg. - 78 31/32" =Black=	-	-	-	-	-	1	-	-	-
15	600428B	Roller Assembly 8" Dia. Left-Hand, 2 Blade, 38" Spg. - 78 31/32" =Black=	-	-	-	-	-	1	-	-	-
16	600913B	Roller Assembly 8" Dia. Center Left-Hand, 3 Blade, 30" Spg. - 88 13/32" =Black=	-	-	-	-	-	-	1	-	-
17	600916B	Roller Assembly 8" Dia. Center Right-Hand, 3 Blade, 30" Spg. - 88 13/32" =Black=	-	-	-	-	-	-	1	-	-
18	600294B	Roller Assembly 8" Dia. Center Left-Hand, 3 Blade, 36" Spg. - 108 5/8" =Black=	-	-	-	-	-	-	-	1	-
19	600386B	Roller Assembly 8" Dia. Center Right-Hand, 3 Blade, 36" Spg. - 108 5/8" =Black=	-	-	-	-	-	-	-	1	-
20	600293B	Roller Assembly 8" Dia. Right-Hand, 3 Blade, 36" Spg. - 109 13/16" =Black=	-	-	-	-	-	-	-	1	-
21	600295B	Roller Assembly 8" Dia. Left-Hand, 3 Blade, 36" Spg. - 109 13/16" =Black=	-	-	-	-	-	-	-	1	-
22	600479B	Roller Assembly 8" Dia. Center Left-Hand, 3 Blade, 38" Spg. - 111 1/8" =Black=	-	-	-	-	-	-	-	-	1
23	600488B	Roller Assembly 8" Dia. Center Right-Hand, 3 Blade, 38" Spg. - 111 1/8" =Black=	-	-	-	-	-	-	-	-	1
24	600486B	Roller Assembly 8" Dia. Right-Hand, 3 Blade, 38" Spg. - 117 25/32" =Black=	-	-	-	-	-	-	-	-	1
25	600482B	Roller Assembly 8" Dia. Left-Hand, 3 Blade, 38" Spg. - 117 25/32" =Black=	-	-	-	-	-	-	-	-	1
26	603730B	Roller Assembly 8" Dia. Rear - 13" =Black=	1	1	1	1	3	3	3	3	3

COVER CROP ROLLER ATTACHMENT — Parts

Front Roller & Deflector Components

Please visit www.unverferth.com/parts/ for the most current parts listing.

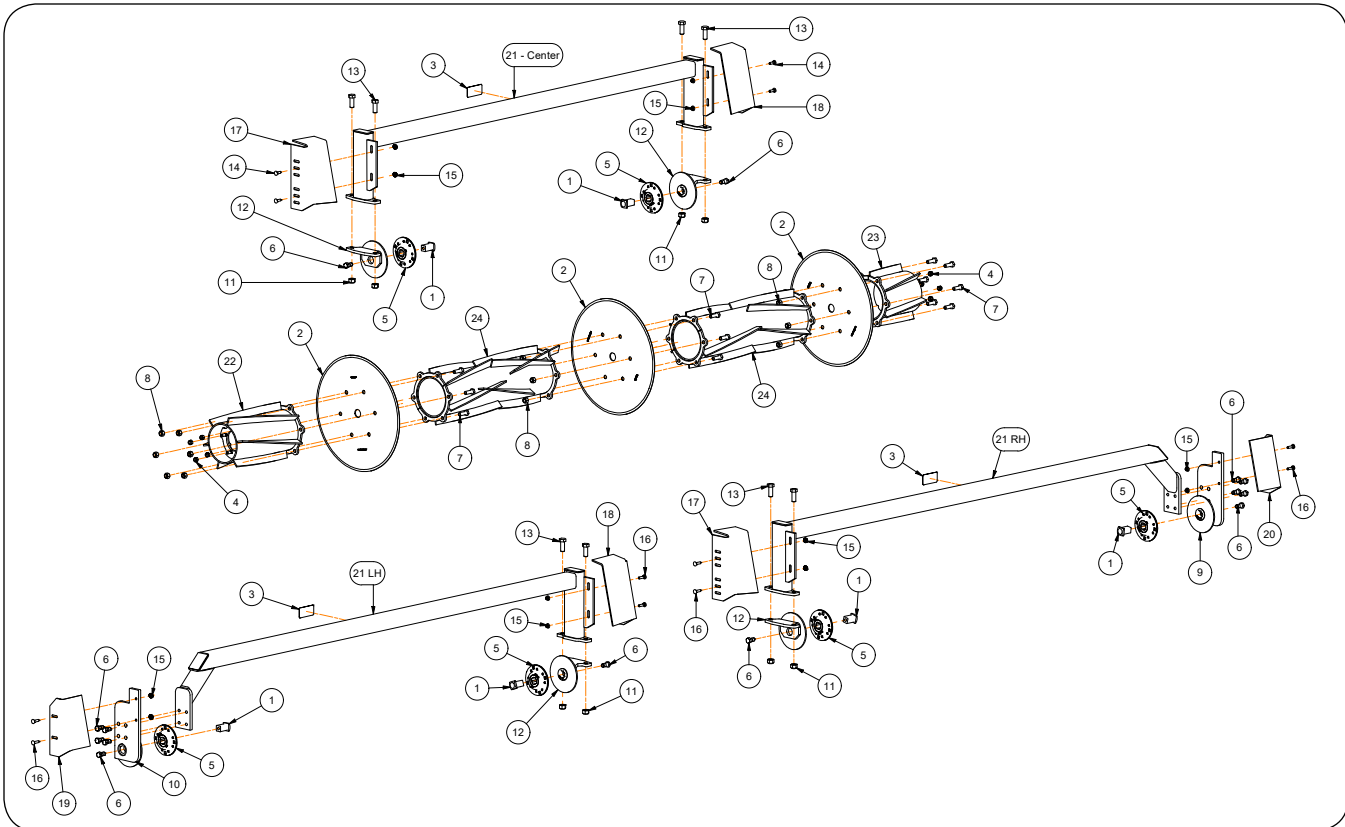

ITEM	PART NUMBER	DESCRIPTION	QTY.									
			6 Shank 30" Spacing	6 Shank 36" Spacing	6 Shank 38" Spacing	8 Shank 30" Spacing	8 Shank 36" Spacing	8 Shank 38" Spacing	12 Shank 30" Spacing	12 Shank 36" Spacing	12 Shank 38" Spacing	
1	74280	Bearing Bolt 1.125 SQ. x 2 1/16" (Square Cast)	4	4	4	4	8	8	8	8	8	
2	9501619	Coulter Blade 20" Dia. Smooth	6	6	6	8	8	8	12	12	12	
3	901543	Decal Important Direction	2	2	2	2	4	4	4	4	4	
4	9398-015	Elastic Locknut 1/2"-20UNF	16	16	16	16	32	32	32	32	32	
5	902714	Flange Bearing 1 1/8" SQ. Bore	4	4	4	4	8	8	8	8	8	
6	900872	Capscrew 5/8"-11UNC x 1 1/4" G5	4	4	4	4	16	16	8	16	16	
7	9390-123	Capscrew 5/8"-11UNC x 1 3/4" G5	36	36	36	48	48	48	72	72	72	
8	9801	Lock Nut/Top 5/8"-11UNC	36	36	36	49	48	48	72	72	72	
9	604661B	Bearing Mount Weldment RH	-	-	-	-	1	1	-	1	1	
10	604725B	Bearing Mount Weldment LH	-	-	-	-	1	1	-	1	1	
11	9802	Lock Nut 3/4"-10UNC	8	8	8	8	12	12	16	12	12	
12	600325B	Bearing Mount Weldment	4	4	4	4	6	6	8	6	6	
13	9390-145	Capscrew 3/4"-10UNC x 2"	8	8	8	8	12	12	16	12	12	
14	9388-052	Carrige Bolt 3/8"-16UNC x 1 1/4" G5	8	8	8	8	12	12	16	12	12	
15	91263	Flange Nut 3/8"-16 UNC	8	8	8	8	16	16	16	16	16	
16	9388-053	Carrige Bolt 3/8"-16UNC x 1 1/2" G5	-	-	-	-	4	4	-	4	4	
17	603209B	Deflector RH	2	2	2	2	3	3	4	3	3	
18	603208B	Deflector LH	2	2	2	2	3	3	4	3	3	
19	604724B	Deflector RH	-	-	-	-	1	1	-	1	1	
20	604719B	Deflector LH	-	-	-	-	1	1	-	1	1	

COVER CROP ROLLER ATTACHMENT — Parts

Front Roller & Deflector Components

Please visit www.unverferth.com/parts/ for the most current parts listing.

ITEM	PART NUMBER	DESCRIPTION	QTY.											
			6 Shank 30" Spacing	6 Shank 36" Spacing	6 Shank 38" Spacing	8 Shank 30" Spacing	8 Shank 36" Spacing	8 Shank 38" Spacing	12 Shank 30" Spacing	12 Shank 36" Spacing	12 Shank 38" Spacing			
21	600465B	Main Roller Arm Weldment 3 Blade; Center LH/RH	2	-	-	-	-	-	-	-	2	-	-	
	600521B	Main Roller Arm Weldment 3 Blade; Center LH/RH	-	2	-	-	-	-	-	-	-	-	-	
	600873B	Main Roller Arm Weldment 3 Blade; Center LH/RH	-	-	2	-	-	-	-	-	-	-	-	
	600625B	Main Roller Arm Weldment 4 Blade; Center LH/RH	-	-	-	2	-	-	-	-	-	-	-	
	600538B	Main Roller Arm Weldment 2 Blade; Center LH/RH	-	-	-	-	2	-	-	-	-	-	-	
	600692B	Main Roller Arm Weldment 2 Blade; RH	-	-	-	-	1	-	-	-	-	-	-	
	600685B	Main Roller Arm Weldment 3 Blade; LH	-	-	-	-	1	-	-	-	-	-	-	
	600416B	Main Roller Arm Weldment 2 Blade; Center LH/RH	-	-	-	-	-	2	-	-	-	-	-	
	600443B	Main Roller Arm Weldment 2 Blade; RH	-	-	-	-	-	1	-	-	-	-	-	
	600426B	Main Roller Arm Weldment 2 Blade; LH	-	-	-	-	-	1	-	-	-	-	-	
	600912B	Main Roller Arm Weldment 3 Blade; LH/RH	-	-	-	-	-	-	-	2	-	-	-	
	600302B	Main Roller Arm Weldment 3 Blade; Center LH/RH	-	-	-	-	-	-	-	-	2	-	-	
	600403B	Main Roller Arm Weldment 3 Blade; RH	-	-	-	-	-	-	-	-	1	-	-	
	600300B	Main Roller Arm Weldment 3 Blade; LH	-	-	-	-	-	-	-	-	1	-	-	
	600493B	Main Roller Arm Weldment 3 Blade; Center LH/RH	-	-	-	-	-	-	-	-	-	2	-	
600487B	Main Roller Arm Weldment 3 Blade; RH	-	-	-	-	-	-	-	-	-	-	1		
600483B	Main Roller Arm Weldment 3 Blade; LH	-	-	-	-	-	-	-	-	-	-	1		
22	601302B	Roller Weldment - 10" LH	1	-	-	-	-	-	-	1	-	-	-	
	600458B	Roller Weldment - 11" LH	-	-	-	-	-	-	-	1	-	-	-	
	600508B	Roller Weldment - 11" LH	-	-	-	1	-	-	-	1	-	-	-	
	600693B	Roller Weldment - 12" LH	-	-	-	-	1	-	-	-	1	-	-	
	600422B	Roller Weldment - 14" LH	-	1	-	-	-	-	-	-	1	1	-	
	600835B	Roller Weldment - 15" LH	-	-	1	-	1	2	-	-	-	1	-	
	600512B	Roller Weldment - 15" LH	-	-	-	-	-	1	-	-	-	-	-	
	600287B	Roller Weldment - 16" LH	-	-	-	-	-	-	-	-	1	-	-	
	600445B	Roller Weldment - 16" LH	-	-	-	-	-	-	-	-	-	-	1	
	600537B	Roller Weldment - 17" LH	1	-	-	1	1	-	1	-	-	-	-	
600290B	Roller Weldment - 20" LH	-	1	1	-	1	1	-	1	1	1	1		
23	601303B	Roller Weldment - 10" RH	1	-	-	-	-	-	-	1	-	-	-	
	600460B	Roller Weldment - 11" RH	-	-	-	-	-	-	-	1	-	-	-	
	600504B	Roller Weldment - 11" RH	-	-	-	1	-	-	-	1	-	-	-	
	600681B	Roller Weldment - 12" RH	-	-	-	-	1	-	-	-	1	-	-	
	600489B	Roller Weldment - 14" RH	-	1	-	-	-	-	-	-	1	1	-	
	600513B	Roller Weldment - 15" RH	-	-	-	-	-	1	-	-	-	-	-	
	600532B	Roller Weldment - 15" RH	-	-	1	-	1	2	-	-	-	1	-	
	600384B	Roller Weldment - 16" RH	-	-	-	-	-	-	-	-	-	1	-	
	600431B	Roller Weldment - 16" RH	-	-	-	-	-	-	-	-	-	-	1	
	600464B	Roller Weldment - 17" RH	1	-	-	-	1	-	1	-	1	-	-	
600837B	Roller Weldment - 17" RH	-	-	-	1	-	-	-	-	-	-	-		
600288B	Roller Weldment - 20" RH	-	1	1	-	1	1	-	1	1	1	1		
24	600296B	Roller Weldment - 35 13/16" Center	-	4	-	-	4	-	-	-	8	-	-	
	600417B	Roller Weldment - 37 13/16" Center	-	-	4	-	-	4	-	-	-	8	-	
	600728B	Roller Weldment - 29 13/16" Center	4	-	-	6	-	-	-	8	-	-	-	

COVER CROP ROLLER ATTACHMENT — Parts

Rear Roller & Deflector Components

Please visit www.unverferth.com/parts/ for the most current parts listing.

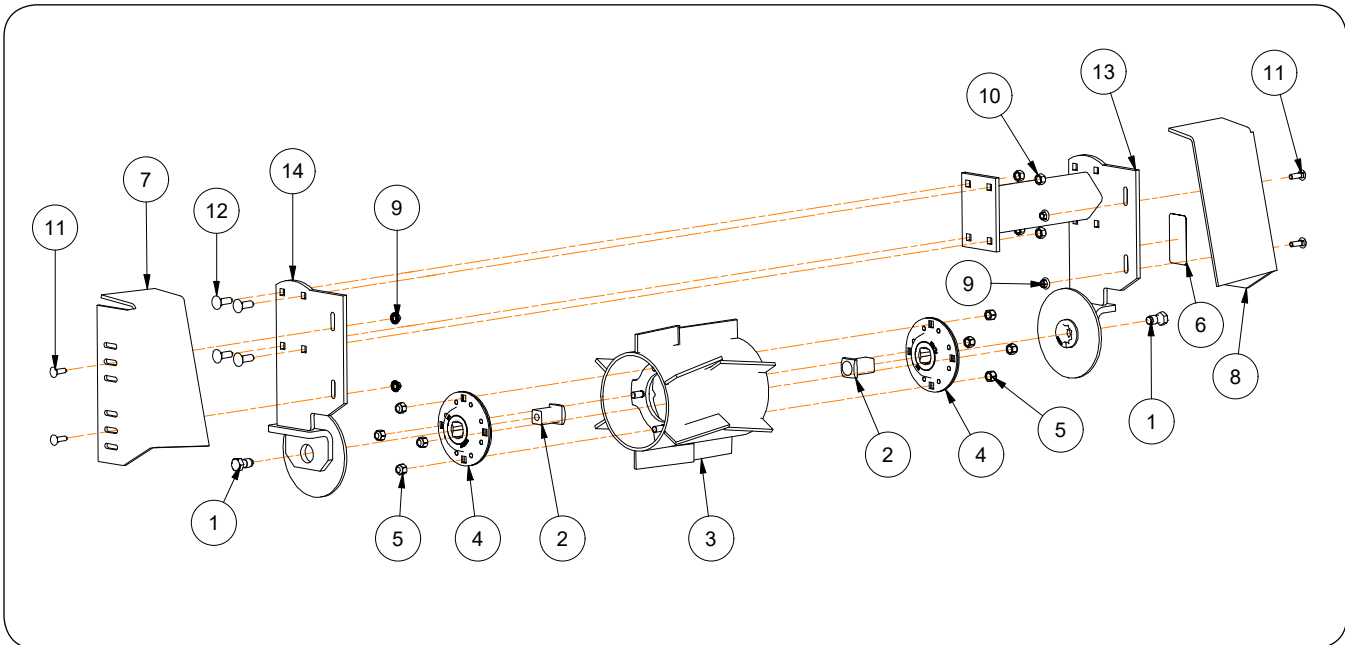

ITEM	PART NUMBER	DESCRIPTION	QTY.								
			6 Shank 30" Spacing	6 Shank 36" Spacing	6 Shank 38" Spacing	8 Shank 30" Spacing	8 Shank 36" Spacing	8 Shank 38" Spacing	12 Shank 30" Spacing	12 Shank 36" Spacing	12 Shank 38" Spacing
	603730B	Roller Assembly Rear 13" =Black=	1	1	1	1	3	3	3	3	3
1	900872	Capscrew 5/8"-11UNC x 1 1/4" G5	2	2	2	2	6	6	6	6	6
2	74280	Bearing Bolt 1.125 SQ. x 2 1/16" (Square Cast Bearing Insert)	2	2	2	2	6	6	6	6	6
3	603713B	Roller Weldment 11" (1/4" Wall)	1	1	1	1	3	3	3	3	3
4	902714	Flange Bearing 1 1/8" SQ. Bore	2	2	2	2	6	6	6	6	6
5	9398-015	Elastic Locknut 1/2"-20UNF	8	8	8	8	24	24	24	24	24
6	901543	Decal Important Direction	1	1	1	1	3	3	3	3	3
7	603208B	Deflector Right-Hand	1	1	1	1	3	3	3	3	3
8	603209B	Deflector Left-Hand	1	1	1	1	3	3	3	3	3
9	91263	Flange Nut 3/8"-16	4	4	4	4	12	12	12	12	12
10	9800	Lock Nut 1/2"-13UNC	4	4	4	4	12	12	12	12	12
11	9388-052	Carriage Bolt 3/8"-16UNC x 1 1/4"	4	4	4	4	12	12	12	12	12
12	9388-104	Carriage Bolt 1/2"-13UNC x 1 1/2"	4	4	4	4	12	12	12	12	12
13	603718B	LH Roller Frame Weldment 12"	1	1	1	1	3	3	3	3	3
14	603717B	RH Roller Frame Weldment 12"	1	1	1	1	3	3	3	3	3

COVER CROP ROLLER ATTACHMENT — Parts

Front Mounting Post Components

Please visit www.unverferth.com/parts/ for the most current parts listing.

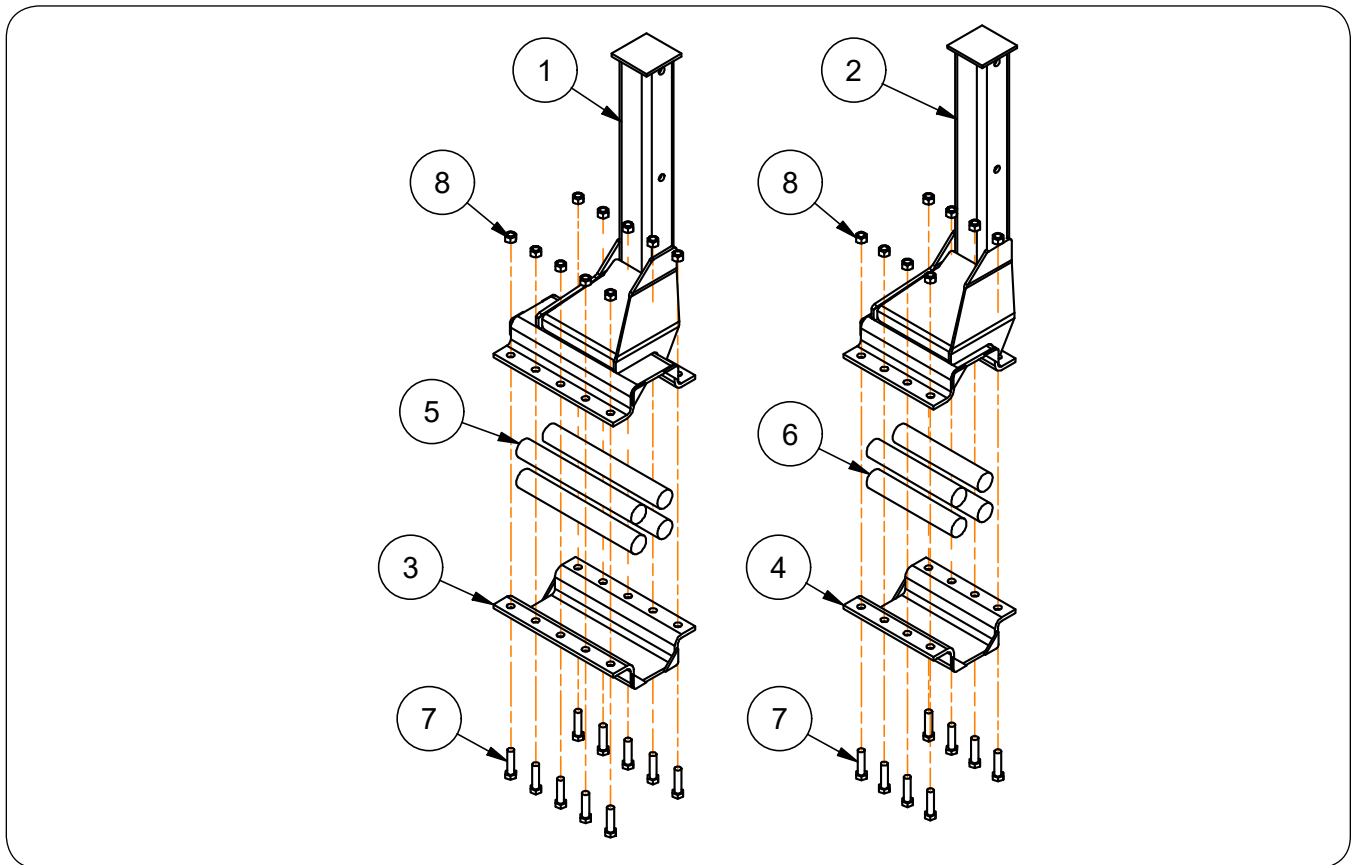

ITEM	PART NUMBER	DESCRIPTION	QTY.									
			6 Shank 30" Spacing	6 Shank 36" Spacing	6 Shank 38" Spacing	8 Shank 30" Spacing	8 Shank 36" Spacing	8 Shank 38" Spacing	12 Shank 30" Spacing	12 Shank 36" Spacing	12 Shank 38" Spacing	
1	600309B	Front Mounting Post (10 Mounting Holes) (Roller Frame Arm Weldment)	4	4	4	4	6	6	4	8	8	
2	600734B	Front Mounting Post (8 Mounting Holes) (Roller Frame Arm Weldment)	-	-	-	-	2	2	6	-	-	
3	76950B	Clamp Plate Weldment for 10 Mounting Hole Front Post	4	4	4	4	6	6	4	8	8	
4	600353B	Clamp Plate Weldment for 8 Mounting Hole Front Post	-	-	-	-	2	2	6	-	-	
5	76956	Spring Rod 1 1/2" Dia. x 11 1/2" (Neoprene) for 10 Mounting Hole Front Post	16	16	16	16	24	24	16	32	32	
6	600355	Spring Rod 1 1/2" Dia. x 8 1/2" (Neoprene) for 8 Mounting Hole Front Post	-	-	-	-	8	8	24	-	-	
7	97369	Capscrew 1/2"-13UNC x 2" Full Threaded	40	40	40	40	76	76	88	80	80	
8	9800	Lock Nut/Top 1/2"-13UNC	40	40	40	40	76	76	88	80	80	

COVER CROP ROLLER ATTACHMENT — Parts

Rear Mounting Post Components

Please visit www.unverferth.com/parts/ for the most current parts listing.

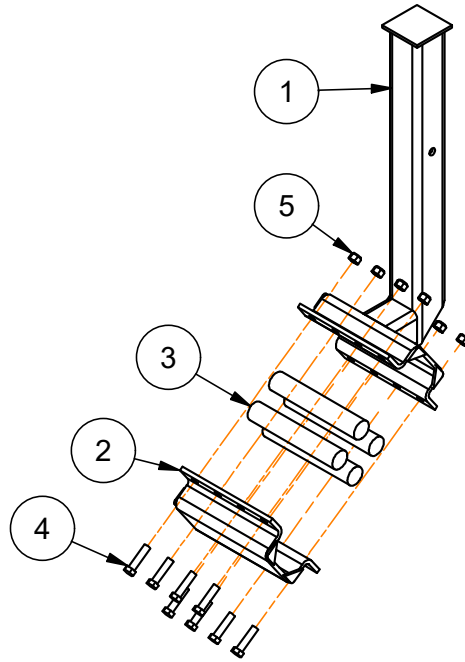

ITEM	PART NUMBER	DESCRIPTION	QTY.									
			6 Shank 30" Spacing	6 Shank 36" Spacing	6 Shank 38" Spacing	8 Shank 30" Spacing	8 Shank 36" Spacing	8 Shank 38" Spacing	12 Shank 30" Spacing	12 Shank 36" Spacing	12 Shank 38" Spacing	
1	600351B	Rear Mounting Post (8 Mounting Holes) (Roller Frame Arm Weldment)	1	1	1	1	3	3	3	3	3	
2	600353B	Clamp Plate Weldment for 8 Mounting Hole Front Post	1	1	1	1	3	3	3	3	3	
3	600355	Spring Rod 1 1/2" Dia. x 8 1/2" (Neoprene) for 8 Mounting Hole Front Post	4	4	4	4	12	12	12	12	12	
4	97369	Capscrew 1/2"-13UNC x 2" Full Threaded	8	8	8	8	24	24	24	24	24	
5	9800	Lock Nut/Top 1/2"-13UNC	8	8	8	8	24	24	24	24	24	

NOTES



Unverferth[®]
Manufacturing Company, Inc.

www.unverferth.com